



Hillsdale Terminal Data Sheets

Ring Type	A.W.G.
Uninsulated	22-18
Brazed	
High Temp	
Vinyl	
Nylon	
3-Piece	
Heat Shrink	
Uninsulated	16-14
Brazed	
High Temp	
Vinyl	
Nylon	
3-Piece	
Heat Shrink	
Uninsulated	12-10
Brazed	
High Temp	
Vinyl	
Nylon	
3-Piece	
Heat Shrink	
Uninsulated	8 AWG 6 AWG 4 AWG 2 AWG
High Temp	
Vinyl	
Nylon	
Heat Shrink	

Spade Type	A.W.G.
Uninsulated	22-18
Brazed	
High Temp	
Vinyl	
Nylon	
3-Piece	
Heat Shrink	
Uninsulated	16-14
Brazed	
High Temp	
Vinyl	
Nylon	
3-Piece	
Heat Shrink	
Uninsulated	12-10
Brazed	
High Temp	
Vinyl	
Nylon	
3-Piece	
Heat Shrink	
Uninsulated	8+

Butt Type
Uninsulated
Vinyl Extruded
Nylon Extruded
Nylon Molded
Economy
Heat Shrink

Select green "Home" button on datasheet to return to this page



Hillsdale Terminal

Phone: 1-800-447-3150

Email: sales@hillsdaleterminal.com

22-18 A.W.G. Uninsulated Rings

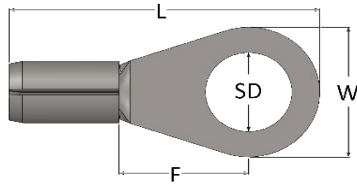

- 110 Copper Alloy .028 thickness, Electro-Tin Plated .0001"-.0003"
- Terminal I.D. - .078

Part #	Stud Size	Barrel Length	Length	W	Stud Diameter(SD)	F	Voltage
10014	4	.250	.590	.225	.122/.125	.223	600
10020*	6	.250	.660	.290	.139/.142	.260	600
10020E	6	.190	.586	.290	.138/.142	.250	600
10021	6 Slim	.250	.590	.225	.139/.142	.223	600
10021E	6 Slim	.190	.523	.225	.138/.142	.223	600
10030*	8	.250	.660	.324	.168/.171	.250	600
10038	8 Slim	.250	.660	.290	.168/.171	.260	600
10038E	8 Slim	.190	.586	.290	.168/.171	.250	600
10040*	10	.250	.660	.324	.194/.197	.250	600
10040E	10	.190	.586	.290	.194/.197	.253	600
10041*	1/4	.250	.890	.470	.260/.265	.405	600
10044*	1/4 Slim	.250	.810	.430	.263/.265	.345	600
10042*	5/16	.250	.890	.470	.324/.327	.405	600
10042E	5/16	.190	.828	.470	.324/.327	.405	600
10043*	3/8	.250	.990	.558	.394/.398	.469	600
10040M*	6-8-10	.250	.812	.340	NA	.345	600

All dimensions are in Inches

* =UL and CSA listed

~ =CSA listed

Required per UL/CSA Requirements:

75° C Max. Temperature Rating

One crimp required

Solid or Stranded wire

Crimp tool HT #20591-NH1

Strip Length 1/4" (6.4mm)

Agency and Compliance:

UL Listed, investigated to UL 486 A-B, File NO. ZMVV.E68376

CSA 22.2 No. 65-03, Certification NO. 207131

Min. Wire Pullout Force	22AWG	8lbs.
	20AWG	13lbs.
	18AWG	20lbs.

WARNING! Installation of electrical wire and terminals can be hazardous if done improperly. Improper use can result in personal injury or property damage. For safe wiring practices, consult National Electrical Code and/or your local building inspector. A licensed electrical contractor or engineer must be consulted to determine that the correct wire and terminal size is used and that it is properly and safely installed for all applications.

All statements, procedural information, and recommendations related to Hillsdale Terminal's products are based on data believed to be reliable, but the precision or completeness is not definite. Before using this product, you must evaluate it and determine if it is suitable for your intended application. You accept all risks and liability associated with such use. Any statements related to the product which are not in Hillsdale Terminal's current publications shall have no force or effect unless expressly agreed upon, in writing, by a sanctioned member of Hillsdale Terminal

Terms and Conditions at www.hillsdaleterminal.com

[HOME](#)



Hillsdale Terminal

Phone: 1-800-447-3150

Email: sales@hillsdaleterminal.com

16-14 A.W.G. Uninsulated Rings

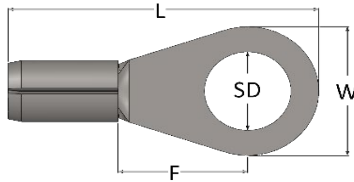

- 110 Copper Alloy .030 thickness, Electro-Tin Plated .0001"-.0003"
- Terminal I.D. - .093

Part #	Stud Size	Barrel Length	Length	W	Stud Diameter(SD)	F	Voltage
10084	4	.250	.570	.264	.122/.125	.195	600
10086*	6	.250	.650	.295	.138/.142	.260	600
10086E	6	.188	.588	.295	.139/.142	.260	600
10085	6 Slim	.250	.570	.246	.139/.142	.195	600
10090*	8	.250	.710	.324	.168/.171	.295	600
10098	8 Slim	.250	.650	.295	.168/.172	.260	600
10098E	8 Slim	.188	.588	.295	.168/.172	.260	600
10100*	10	.250	.710	.324	.194/.197	.295	600
10100E	10	.188	.644	.324	.194/.197	.295	600
10101*	1/4	.250	.890	.470	.263/.265	.405	600
10114*	1/4 Slim	.250	.810	.430	.263/.265	.345	600
10114E	1/4 Slim	.188	.750	.430	.263/.265	.345	600
10102*	5/16	.250	.890	.470	.324/.327	.405	600
10102E	5/16	.188	.827	.470	.324/.327	.405	600
10103*	3/8	.250	.990	.558	.394/.398	.569	600
10104*	1/2	.250	1.210	.430	.525/.530	.615	600
10100M*	6-8-10	.250	.810	.340	NA	.345	600

All dimensions are in Inches

* =UL and CSA listed

~ =CSA listed

Required per UL/CSA Requirements:

75° C Max. Temperature Rating

One crimp required

Solid or Stranded wire

Crimp tool HT #20591-NH1

Strip Length 1/4" (6.4mm)

Min. Wire Pullout Force	16AWG	30lbs.
	14AWG	50lbs.

Agency and Compliance:

UL Listed, investigated to UL 486 A-B, File NO. ZMVV.E68376

CSA 22.2 No. 65-03, Certification NO. 207131

WARNING! Installation of electrical wire and terminals can be hazardous if done improperly. Improper use can result in personal injury or property damage. For safe wiring practices, consult National Electrical Code and/or your local building inspector. A licensed electrical contractor or engineer must be consulted to determine that the correct wire and terminal size is used and that it is properly and safely installed for all applications.

All statements, procedural information, and recommendations related to Hillsdale Terminal's products are based on data believed to be reliable, but the precision or completeness is not definite. Before using this product, you must evaluate it and determine if it is suitable for your intended application. You accept all risks and liability associated with such use. Any statements related to the product which are not in Hillsdale Terminal's current publications shall have no force or effect unless expressly agreed upon, in writing, by a sanctioned member of Hillsdale Terminal

Terms and Conditions at www.hillsdaleterminal.com

[HOME](#)



Hillsdale Terminal

Phone: 1-800-447-3150

Email: sales@hillsdaleterminal.com

12-10 A.W.G. Uninsulated Rings

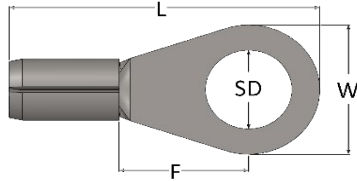

- 110 Copper Alloy .038 thickness, Electro-Tin Plated .00025"-.0004"
- Terminal I.D. - .141/.144

Part #	Stud Size	Barrel Length	Length	W	Stud Diameter(SD)	F	Voltage
10210*	6	.250	.720	.342	.143/.147	.297	600
10215	6 Slim	.250	.720	.290	.143/.147	.297	600
10220*	8	.250	.720	.342	.168/.171	.297	600
10225	8 Slim	.250	.720	.290	.168/.171	.297	600
10230*	10	.250	.720	.342	.194/.197	.297	600
10240*	1/4	.250	.990	.558	.257/.261	.469	600
10245*	1/4 Slim	.250	.940	.434	.257/.261	.469	600
10250*	5/16	.250	.990	.558	.327/.323	.469	600
10260*	3/8	.250	.990	.558	.400/.394	.469	600
10233*	1/2	.250	1.210	.690	.525/.530	.615	600
10235	1/2 Wide	.250	1.250	.760	.518/.522	.620	600
10230M*	6-8-10	.250	.890	.390	NA	.350	600

All dimensions are in Inches

* =UL and CSA listed

~ =CSA listed

Required per UL/CSA Requirements:

75° C Max. Temperature Rating

One crimp required

Solid or Stranded wire

Crimp tool HT #20591-NH1

Strip Length 1/4" (6.4mm)

Min. Wire Pullout Force	12AWG	70lbs.
	10AWG	80lbs.

Agency and Compliance:

UL Listed, investigated to UL 486 A-B, File NO. ZMVV.E68376

CSA 22.2 No. 65-03, Certification NO. 207131

WARNING! Installation of electrical wire and terminals can be hazardous if done improperly. Improper use can result in personal injury or property damage. For safe wiring practices, consult National Electrical Code and/or your local building inspector. A licensed electrical contractor or engineer must be consulted to determine that the correct wire and terminal size is used and that it is properly and safely installed for all applications.

All statements, procedural information, and recommendations related to Hillsdale Terminal's products are based on data believed to be reliable, but the precision or completeness is not definite. Before using this product, you must evaluate it and determine if it is suitable for your intended application. You accept all risks and liability associated with such use. Any statements related to the product which are not in Hillsdale Terminal's current publications shall have no force or effect unless expressly agreed upon, in writing, by a sanctioned member of Hillsdale Terminal

Terms and Conditions at www.hillsdaleterminal.com





Hillsdale Terminal

Phone: 1-800-447-3150

Email: sales@hillsdaleterminal.com

8-2 A.W.G Uninsulated Rings

Material Thickness:

8 AWG: .042

6 AWG: .050

4 AWG: .070

2 AWG: .070

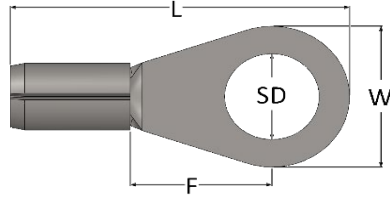

- Alloy 110 Copper with brazed seam.
- Electro-Tin Plated .00025-.0004 thick

A.W.G	Part #	Stud Size	Barrel Length	Length	W	Stud Diameter(SD)	F	Voltage
8	10608*	#8	.330	.875	.375	.173/.175	.358	600
	10609*	#8-10 Slim	.330	.875	.375	.197/.200	.358	600
	10610*	#8-10	.330	.93	.472	.197/.200	.358	600
	10611*	#12-1/4	.330	.93	.472	.262/.265	.358	600
	10612*	5/16	.330	1.16	.590	.340/.343	.535	600
	10613*	3/8	.330	1.16	.590	.389/.391	.535	600
	10614*	1/2	.330	1.32	.780	.515/.520	.620	600
6	10615*	#8-10	.375	1.14	.470	.197/.200	.530	600
	10615E*	#8-10	.375	1.00	.470	.197/.200	.390	600
	10616*	#12-1/4	.375	1.14	.470	.262/.265	.530	600
	10616E*	#12-1/4	.375	1.00	.470	.262/.265	.390	600
	10617*	5/16	.375	1.22	.620	.325/.328	.530	600
	10618*	3/8	.375	1.22	.620	.397/.400	.530	600
	10619	1/2	.375	1.60	.860	.518/.522	.750	600
4	10898	#10	.467	1.25	.468	.197/.200	.546	600
	10620*	1/4	.470	1.35	.656	.262/.265	.546	600
	10899	1/4	.467	1.25	.468	.262/.265	.546	600
	10621*	5/16	.470	1.35	.656	.325/.328	.546	600
	10622*	3/8	.470	1.35	.656	.397/.400	.546	600
	10623*	1/2	.470	1.60	.860	.518/.522	.750	600
2	10628	1/4	.50	1.55	.625	.262/.265	.710	600
	10629	5/16	.50	1.55	.625	.325/.328	.710	600
	10630	3/8	.50	1.55	.625	.397/.400	.710	600
	10631	1/2	.50	1.60	.860	.518/.522	.710	600

All dimensions are in inches

* =UL and CSA listed

~ =CSA listed

Required per UL/CSA Requirements:

75° C Max. Temperature Rating

One crimp required

Solid or Stranded wire

Crimp tool HT #20701 Hex Crimp Jr.

Strip Length 15/32"

Agency and Compliance:

UL Listed, investigated to UL 486 A-B, File NO. ZMVV.E68376

CSA 22.2 No. 65-03, Certification NO. 207131

Min. Wire Pullout Force	8AWG	90lbs.
	6AWG	100lbs.
	4AWG	140lbs.
	2AWG	180lbs.

WARNING! Installation of electrical wire and terminals can be hazardous if done improperly. Improper use can result in personal injury or property damage. For safe wiring practices, consult National Electrical Code and/or your local building inspector. A licensed electrical contractor or engineer

must be consulted to determine that the correct wire and terminal size is used and that it is properly and safely installed for all applications.

All statements, procedural information, and recommendations related to Hillsdale Terminal's products are based on data believed to be reliable, but the precision or completeness is not definite. Before using this product, you must evaluate it and determine if it is suitable for your intended application. You accept all risks and liability associated with such use. Any statements related to the product which are not in Hillsdale Terminal's current publications shall have no force or effect unless expressly agreed upon, in writing, by a sanctioned member of Hillsdale Terminal

Terms and Conditions at www.hillsdaleterminal.com

[HOME](#)



Hillsdale Terminal

Phone: 1-800-447-3150

Email: sales@hillsdaleterminal.com

22-18 A.W.G. High Temp Rings

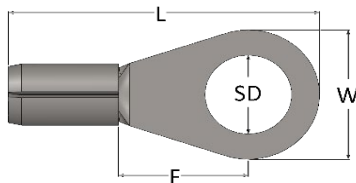

- 1008 Alloy steel .028 thickness
- Nickel Plated for 900° rating
- Terminal I.D. - .078

Part #	Stud Size	Barrel Length	Length	W	Stud Diameter(SD)	F	Voltage
10020HT	6	.250	.660	.290	.139/.142	.260	600
10030HT	8	.250	.660	.324	.168/.171	.250	600
10038HT	8 Slim	.250	.660	.290	.168/.171	.260	600
10040HT	10	.250	.660	.324	.194/.197	.250	600
10041HT	1/4	.250	.890	.470	.260/.265	.405	600
10042HT	1/3	.250	.890	.470	.324/.327	.405	600
10043HT	3/8	.250	.990	.558	.394/.398	.469	600

All dimensions are in Inches

Instructions

482° C Max. Temperature Rating

One crimp required

Solid or Stranded wire

Crimp tool HT #20591-NH1

Strip Length 1/4" (6.4mm)

Min. Wire Pullout Force	22AWG	8lbs.
	20AWG	13lbs.
	18AWG	20lbs.

WARNING! Installation of electrical wire and terminals can be hazardous if done improperly. Improper use can result in personal injury or property damage. For safe wiring practices, consult National Electrical Code and/or your local building inspector. A licensed electrical contractor or engineer must be consulted to determine that the correct wire and terminal size is used and that it is properly and safely installed for all applications.

All statements, procedural information, and recommendations related to Hillsdale Terminal's products are based on data believed to be reliable, but the precision or completeness is not definite. Before using this product, you must evaluate it and determine if it is suitable for your intended application. You accept all risks and liability associated with such use. Any statements related to the product which are not in Hillsdale Terminal's current publications shall have no force or effect unless expressly agreed upon, in writing, by a sanctioned member of Hillsdale Terminal

Terms and Conditions at www.hillsdaleterminal.com

[HOME](#)



Hillsdale Terminal

Phone: 1-800-447-3150

Email: sales@hillsdaleterminal.com

16-14 A.W.G. High Temp Rings

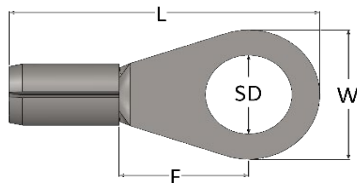

- 1008 Alloy steel .030 thickness
- Nickel Plated for 900°F rating
- Terminal I.D. - .093

Part #	Stud Size	Barrel Length	Length	W	Stud Diameter(SD)	F	Voltage
10086HT	6	.250	.650	.295	.138/.142	.260	600
10090HT	8	.250	.710	.324	.168/.171	.295	600
10100HT	10	.250	.710	.324	.194/.197	.295	600
10101HT	1/4	.250	.890	.470	.263/.265	.405	600
10114HT	1/4 Slim	.250	.810	.430	.263/.265	.345	600
10102HT	5/16	.250	.890	.470	.324/.327	.405	600
10103HT	3/8	.250	.990	.558	.394/.398	.569	600

All dimensions are in Inches

Instructions

482° C Max. Temperature Rating

One crimp required

Solid or Stranded wire

Crimp tool HT #20591-NH1

Strip Length 1/4" (6.4mm)

Min. Wire Pullout Force	16AWG	30lbs.
	14AWG	50lbs.

WARNING! Installation of electrical wire and terminals can be hazardous if done improperly. Improper use can result in personal injury or property damage. For safe wiring practices, consult National Electrical Code and/or your local building inspector. A licensed electrical contractor or engineer must be consulted to determine that the correct wire and terminal size is used and that it is properly and safely installed for all applications.

All statements, procedural information, and recommendations related to Hillsdale Terminal's products are based on data believed to be reliable, but the precision or completeness is not definite. Before using this product, you must evaluate it and determine if it is suitable for your intended application. You accept all risks and liability associated with such use. Any statements related to the product which are not in Hillsdale Terminal's current publications shall have no force or effect unless expressly agreed upon, in writing, by a sanctioned member of Hillsdale Terminal

Terms and Conditions at www.hillsdaleterminal.com

[HOME](#)



Hillsdale Terminal

Phone: 1-800-447-3150

Email: sales@hillsdaleterminal.com

12-10 A.W.G. High Temp Rings

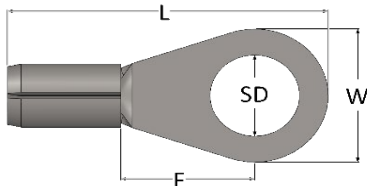

- 1008 Alloy steel .038 thickness
- Nickel Plated for 900°F rating
- Terminal I.D. - .141/.144

Part #	Stud Size	Barrel Length	Length	W	Stud Diameter(SD)	F	Voltage
10210HT	6	.250	.720	.342	.143/.147	.297	600
10220HT	8	.250	.720	.342	.168/.171	.297	600
10230HT	10	.250	.720	.342	.194/.197	.297	600
10240HT	1/4	.250	.990	.558	.257/.261	.469	600
10245HT	1/4 Slim	.250	.940	.434	.257/.261	.469	600
10250HT	5/16	.250	.990	.558	.327/.323	.469	600
10260HT	3/8	.250	.990	.558	.400/.394	.469	600

All dimensions are in Inches

Instructions:

482° C Max. Temperature Rating

One crimp required

Solid or Stranded wire

Crimp tool HT #20591-NH1

Strip Length 1/4" (6.4mm)

Min. Wire Pullout Force	12AWG	70lbs.
	10AWG	80lbs.

WARNING! Installation of electrical wire and terminals can be hazardous if done improperly. Improper use can result in personal injury or property damage. For safe wiring practices, consult National Electrical Code and/or your local building inspector. A licensed electrical contractor or engineer must be consulted to determine that the correct wire and terminal size is used and that it is properly and safely installed for all applications.

All statements, procedural information, and recommendations related to Hillsdale Terminal's products are based on data believed to be reliable, but the precision or completeness is not definite. Before using this product, you must evaluate it and determine if it is suitable for your intended application. You accept all risks and liability associated with such use. Any statements related to the product which are not in Hillsdale Terminal's current publications shall have no force or effect unless expressly agreed upon, in writing, by a sanctioned member of Hillsdale Terminal

Terms and Conditions at www.hillsdaleterminal.com

[HOME](#)



Hillsdale Terminal

Phone: 1-800-447-3150

Email: sales@hillsdaleterminal.com

8-2 A.W.G High Temp Rings

Material Thickness

8 AWG: .042
 6 AWG: .050
 4 AWG: .070
 2 AWG: .070

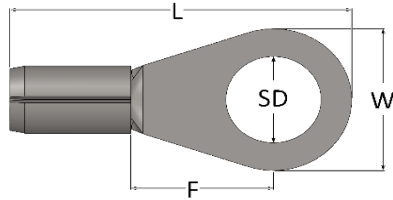

●HT suffix is 1008 alloy steel w/o brazed seam. Nickel plated for 900°F

A.W.G	Part #	Stud Size	Barrel Length	Length	W	Stud Diameter(SD)	F	Voltage
8	10610HT	#8-10	.330	.93	.472	.197/.200	.358	600
	10611HT	#12-1/4	.330	.93	.472	.262/.265	.358	600
	10612HT	5/16	.330	1.16	.590	.340/.343	.535	600
	10613HT	3/8	.330	1.16	.590	.389/.391	.535	600
6	10615HT	#8-10	.375	1.14	.470	.197/.200	.530	600
	10616HT	#12-1/4	.375	1.14	.470	.262/.265	.530	600
	10617HT	5/16	.375	1.22	.620	.325/.328	.530	600
	10618HT	3/8	.375	1.22	.620	.397/.400	.530	600
4	10620HT	1/4	.470	1.35	.656	.262/.265	.546	600
	10621HT	5/16	.470	1.35	.656	.325/.328	.546	600
	10622HT	3/8	.470	1.35	.656	.397/.400	.546	600
2	10628HT	1/4	.50	1.55	.625	.262/.265	.710	600
	10630HT	5/16	.50	1.55	.625	.325/.328	.710	600
	10630HT	3/8	.50	1.55	.625	.397/.400	.710	600

All dimensions are in inches

Instructions:

482° C Max. Temperature Rating
 One crimp required
 Solid or Stranded wire
 Crimp tool HT #20701 Hex Crimp Jr.
 Strip Length 15/32"

Min. Wire Pullout Force	8AWG	90lbs.
	6AWG	100lbs.
	4AWG	140lbs.
	2AWG	180lbs.

WARNING! Installation of electrical wire and terminals can be hazardous if done improperly. Improper use can result in personal injury or property damage. For safe wiring practices, consult National Electrical Code and/or your local building inspector. A licensed electrical contractor or engineer must be consulted to determine that the correct wire and terminal size is used and that it is properly and safely installed for all applications.

All statements, procedural information, and recommendations related to Hillsdale Terminal's products are based on data believed to be reliable, but the precision or completeness is not definite. Before using this product, you must evaluate it and determine if it is suitable for your intended application. You accept all risks and liability associated with such use. Any statements related to the product which are not in Hillsdale Terminal's current publications shall have no force or effect unless expressly agreed upon, in writing, by a sanctioned member of Hillsdale Terminal

Terms and Conditions at www.hillsdaleterminal.com





Hillsdale Terminal

Phone: 1-800-447-3150

Email: sales@hillsdaleterminal.com

22-18 A.W.G. Brazed Rings

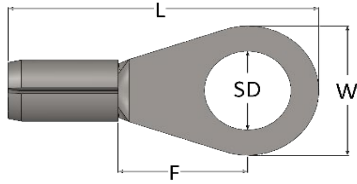

- 110 Copper Alloy .028 thickness, Electro-Tin Plated .0001"-.0003"
- Terminal I.D. - .078

Part #	Stud Size	Barrel Length	Length	W	Stud Diameter(SD)	F	Voltage
10014BZ	4	.250	.590	.225	.122/.125	.223	600
10020BZ*	6	.250	.660	.290	.139/.142	.260	600
10020EBZ	6	.190	.586	.290	.138/.142	.250	600
10021BZ	6 Slim	.250	.590	.225	.139/.142	.223	600
10021EBZ	6 Slim	.190	.523	.225	.138/.142	.223	600
10030BZ*	8	.250	.660	.324	.168/.171	.250	600
10038BZ	8 Slim	.250	.660	.290	.168/.171	.260	600
10038EBZ	8 Slim	.190	.586	.290	.168/.171	.250	600
10040BZ*	10	.250	.660	.324	.194/.197	.250	600
10040EBZ	10	.190	.586	.290	.194/.197	.253	600
10041BZ*	1/4	.250	.890	.470	.260/.265	.405	600
10044BZ*	1/4 Slim	.250	.810	.430	.263/.265	.345	600
10042BZ*	5/16	.250	.890	.470	.324/.327	.405	600
10042EBZ	5/16	.190	.828	.470	.324/.327	.405	600
10043BZ*	3/8	.250	.990	.558	.394/.398	.469	600
10030LBZ	8	.250	.820	.324	.168/.171	.405	600
10040LBZ	10	.250	.820	.324	.194/.197	.405	600
10040MBZ*	6-8-10	.250	.812	.340	NA	.350	600

All dimensions are in Inches

* =UL and CSA listed

~ =CSA listed

Required per UL/CSA Requirements:

75° C Max. Temperature Rating

One crimp required

Solid or Stranded wire

Crimp tool HT #20591-NH1

Strip Length 1/4" (6.4mm)

Agency and Compliance:

UL Listed, investigated to UL 486 A-B, File NO. ZMVV.E68376

CSA 22.2 No. 65-03, Certification NO. 207131

Min. Wire Pullout Force	22AWG	8lbs.
	20AWG	13lbs.
	18AWG	20lbs.

WARNING! Installation of electrical wire and terminals can be hazardous if done improperly. Improper use can result in personal injury or property damage. For safe wiring practices, consult National Electrical Code and/or your local building inspector. A licensed electrical contractor or engineer must be consulted to determine that the correct wire and terminal size is used and that it is properly and safely installed for all applications.

All statements, procedural information, and recommendations related to Hillsdale Terminal's products are based on data believed to be reliable, but the precision or completeness is not definite. Before using this product, you must evaluate it and determine if it is suitable for your intended application. You accept all risks and liability associated with such use. Any statements related to the product which are not in Hillsdale Terminal's current publications shall have no force or effect unless expressly agreed upon, in writing, by a sanctioned member of Hillsdale Terminal



Hillsdale Terminal

Phone: 1-800-447-3150

Email: sales@hillsdaleterminal.com

16-14 A.W.G. Brazed Rings

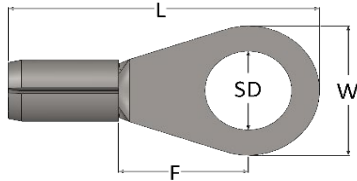

- 110 Copper Alloy .030 thickness, Electro-Tin Plated .0001"-.0003"
- Terminal I.D. - .093

Part #	Stud Size	Barrel Length	Length	W	Stud Diameter(SD)	F	Voltage
10084BZ	4	.250	.570	.264	.122/.125	.195	600
10086BZ*	6	.250	.650	.295	.138/.142	.260	600
10086EBZ	6	.188	.588	.295	.139/.142	.260	600
10085BZ	6 Slim	.250	.570	.246	.139/.142	.195	600
10090BZ*	8	.250	.710	.324	.168/.171	.295	600
10098BZ	8 Slim	.250	.650	.295	.168/.172	.260	600
10098EBZ	8 Slim	.188	.588	.295	.168/.172	.260	600
10100BZ*	10	.250	.710	.324	.194/.197	.295	600
10100EBZ	10	.188	.644	.324	.194/.197	.295	600
10101BZ*	1/4	.250	.890	.470	.263/.265	.405	600
10114BZ*	1/4 Slim	.250	.810	.430	.263/.265	.345	600
10114EBZ	1/4 Slim	.188	.750	.430	.263/.265	.345	600
10102BZ*	5/16	.250	.890	.470	.324/.327	.405	600
10102EBZ	5/16	.188	.827	.470	.324/.327	.405	600
10103BZ*	3/8	.250	.990	.558	.394/.398	.569	600
10104BZ*	1/2	.250	1.210	.430	.525/.530	.615	600
10090LBZ	8	.250	.820	.324	.168/.171	.405	600
10100LBZ	10	.250	.820	.324	.194/.197	.405	600
10100MBZ*	6-8-10	.250	.810	.340	NA	.345	600

All dimensions are in Inches

* =UL and CSA listed

~ =CSA listed

Required per UL/CSA Requirements:

75° C Max. Temperature Rating

One crimp required

Solid or Stranded wire

Crimp tool HT #20591-NH1

Strip Length 1/4" (6.4mm)

Agency and Compliance:

UL Listed, investigated to UL 486 A-B, File NO. ZMVB.E68376

CSA 22.2 No. 65-03, Certification NO. 207131

Min. Wire Pullout Force	16AWG	30lbs.
	14AWG	50lbs.

WARNING! Installation of electrical wire and terminals can be hazardous if done improperly. Improper use can result in personal injury or property damage. For safe wiring practices, consult National Electrical Code and/or your local building inspector. A licensed electrical contractor or engineer must be consulted to determine that the correct wire and terminal size is used and that it is properly and safely installed for all applications.

All statements, procedural information, and recommendations related to Hillsdale Terminal's products are based on data believed to be reliable, but the precision or completeness is not definite. Before using this product, you must evaluate it and determine if it is suitable for your intended application. You accept all risks and liability associated with such use. Any statements related to the product which are not in Hillsdale Terminal's current publications shall have no force or effect unless expressly agreed upon, in writing, by a sanctioned member of Hillsdale Terminal

Terms and Conditions at www.hillsdaleterminal.com





Hillsdale Terminal

Phone: 1-800-447-3150

Email: sales@hillsdaleterminal.com

12-10 A.W.G. Brazed Rings

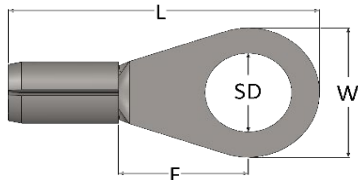

110 Copper Alloy .038 thickness, Electro-Tin Plated .00025"-.0004"

- Terminal I.D. - .141/.144

Part #	Stud Size	Barrel Length	Length	W	Stud Diameter(SD)	F	Voltage
10210BZ*	6	.250	.720	.342	.143/.147	.297	600
10215BZ	6 Slim	.250	.720	.290	.143/.147	.297	600
10220BZ*	8	.250	.720	.342	.168/.171	.297	600
10225BZ	8 Slim	.250	.720	.290	.168/.171	.297	600
10230BZ*	10	.250	.720	.342	.194/.197	.297	600
10240BZ*	1/4	.250	.990	.558	.257/.261	.469	600
10245BZ*	1/4 Slim	.250	.940	.434	.257/.261	.469	600
10250BZ*	5/16	.250	.990	.558	.327/.323	.469	600
10260BZ*	3/8	.250	.990	.558	.400/.394	.469	600
10233BZ*	1/2	.250	1.210	.690	.525/.530	.615	600
10230LBZ	10	.250	.940	.434	.194/.197	.469	600
10230MBZ*	6-8-10	.250	.890	.390	NA	.350	600

All dimensions are in Inches

* =UL and CSA listed

~ =CSA listed

Required per UL/CSA Requirements:

75° C Max. Temperature Rating

One crimp required

Solid or Stranded wire

Crimp tool HT #20591-NH1

Strip Length 1/4" (6.4mm)

Agency and Compliance:

UL Listed, investigated to UL 486 A-B, File NO. ZMVV.E68376

CSA 22.2 No. 65-03, Certification NO. 207131

Min. Wire Pullout Force	12AWG	70lbs.
	10AWG	80lbs.

WARNING! Installation of electrical wire and terminals can be hazardous if done improperly. Improper use can result in personal injury or property damage. For safe wiring practices, consult National Electrical Code and/or your local building inspector. A licensed electrical contractor or engineer must be consulted to determine that the correct wire and terminal size is used and that it is properly and safely installed for all applications.

All statements, procedural information, and recommendations related to Hillsdale Terminal's products are based on data believed to be reliable, but the precision or completeness is not definite. Before using this product, you must evaluate it and determine if it is suitable for your intended application. You accept all risks and liability associated with such use. Any statements related to the product which are not in Hillsdale Terminal's current publications shall have no force or effect unless expressly agreed upon, in writing, by a sanctioned member of Hillsdale Terminal

Terms and Conditions at www.hillsdaleterminal.com

[HOME](#)



Hillsdale Terminal

Phone: 1-800-447-3150

Email: sales@hillsdaleterminal.com

22-18 A.W.G. Vinyl Rings

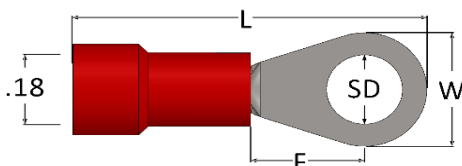

- Terminal I.D. - .078
- 110 Copper Alloy .028 thickness, Electro-Tin Plated .0001"-.0003"
- Rigid PVC Insulator .030 wall thickness

Part #	Stud Size	Barrel Length	Length	W	Stud Diameter(SD)	F	Voltage
50014	4	.250	.80	.225	.122/.125	.223	600
50020*	6	.250	.870	.290	.139/.142	.260	600
50020E	6	.190	.788	.290	.138/.142	.250	600
50021	6 Slim	.250	.80	.225	.139/.142	.223	600
50021E	6 Slim	.190	.718	.225	.138/.142	.223	600
50030*	8	.250	.880	.324	.168/.171	.250	600
50038	8 Slim	.250	.880	.290	.168/.171	.260	600
50038E	8 Slim	.190	.788	.290	.168/.171	.250	600
50040*	10	.250	.880	.324	.194/.197	.250	600
50040E	10	.190	.788	.290	.194/.197	.253	600
50041*	1/4	.250	1.110	.470	.260/.265	.405	600
50044*	1/4 Slim	.250	1.030	.430	.263/.265	.345	600
50044E	1/4 Slim	.190	.960	.430	.263/.265	.345	600
50042*	5/16	.250	1.10	.470	.324/.327	.405	600
50042E	5/16	.190	.828	.470	.324/.327	.405	600
50043*	3/8	.250	1.20	.558	.394/.398	.469	600
50040M	6-8-10	.250	.960	.340	NA	.345	600

All dimensions are in Inches

* =UL and CSA listed

~ =CSA listed

Required per UL/CSA Requirements:

75° C Max. Temperature Rating

One crimp required

Solid or Stranded wire

Crimp tool HT #20592-NH30

Strip Length 9/32" (7.1mm)

Agency and Compliance:

UL Listed, investigated to UL 486 A-B, File NO. ZMVV.E68376

CSA 22.2 No. 65-03, Certification NO. 207131

Min. Wire Pullout Force	22AWG	8lbs.
	20AWG	13lbs.
	18AWG	20lbs.

WARNING! Installation of electrical wire and terminals can be hazardous if done improperly. Improper use can result in personal injury or property damage. For safe wiring practices, consult National Electrical Code and/or your local building inspector. A licensed electrical contractor or engineer must be consulted to determine that the correct wire and terminal size is used and that it is properly and safely installed for all applications.

All statements, procedural information, and recommendations related to Hillsdale Terminal's products are based on data believed to be reliable, but the precision or completeness is not definite. Before using this product, you must evaluate it and determine if it is suitable for your intended application. You accept all risks and liability associated with such use. Any statements related to the product which are not in Hillsdale Terminal's current publications shall have no force or effect unless expressly agreed upon, in writing, by a sanctioned member of Hillsdale Terminal

Terms and Conditions at www.hillsdaleterminal.com

NDME



Hillsdale Terminal

Phone: 1-800-447-3150

Email: sales@hillsdaleterminal.com

16-14 A.W.G. Vinyl Rings

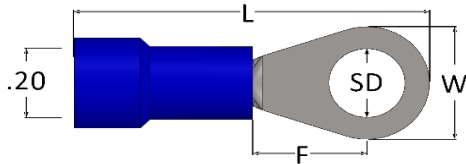

- Terminal I.D. - .093
- 110 Copper Alloy .030 thickness, Electro-Tin Plated .0001"-.0003"
- Rigid PVC Insulator .030 wall thickness

Part #	Stud Size	Barrel Length	Length	W	Stud Diameter(SD)	F	Voltage
50084	4	.250	.880	.264	.122/.125	.195	600
50086*	6	.250	.880	.295	.138/.142	.260	600
50086E	6	.188	.778	.295	.139/.142	.260	600
50085	6 Slim	.250	.790	.246	.139/.142	.195	600
50090*	8	.250	.930	.324	.168/.171	.295	600
50098	8 Slim	.250	.880	.295	.168/.172	.260	600
50098E	8 Slim	.188	.795	.295	.168/.172	.260	600
50100*	10	.250	.930	.324	.194/.197	.295	600
50100E	10	.188	.860	.324	.194/.197	.295	600
50101*	1/4	.250	1.110	.470	.263/.265	.405	600
50114*	1/4 Slim	.250	1.030	.430	.263/.265	.345	600
50114E	1/4 Slim	.188	.970	.430	.263/.265	.345	600
50102*	5/16	.250	1.110	.470	.324/.327	.405	600
50102E	5/16	.188	1.050	.470	.324/.327	.405	600
50103*	3/8	.250	1.210	.558	.394/.398	.569	600
50104*	1/2	.250	1.430	.430	.525/.530	.615	600
50100M*	6-8-10	.250	1.020	.340	NA	.345	600

All dimensions are in Inches

* =UL and CSA listed

~ =CSA listed

Required per UL/CSA Requirements:

75° C Max. Temperature Rating

One crimp required

Solid or Stranded wire

Crimp tool HT #20592-NH30

Strip Length 9/32" (7.1mm)

Agency and Compliance:

UL Listed, investigated to UL 486 A-B, File NO. ZMVV.E68376

CSA 22.2 No. 65-03, Certification NO. 207131

Min. Wire Pullout Force	16AWG	30lbs.
	14AWG	50lbs.

WARNING! Installation of electrical wire and terminals can be hazardous if done improperly. Improper use can result in personal injury or property damage. For safe wiring practices, consult National Electrical Code and/or your local building inspector. A licensed electrical contractor or engineer must be consulted to determine that the correct wire and terminal size is used and that it is properly and safely installed for all applications.

All statements, procedural information, and recommendations related to Hillsdale Terminal's products are based on data believed to be reliable, but the precision or completeness is not definite. Before using this product, you must evaluate it and determine if it is suitable for your intended application. You accept all risks and liability associated with such use. Any statements related to the product which are not in Hillsdale Terminal's current publications shall have no force or effect unless expressly agreed upon, in writing, by a sanctioned member of Hillsdale Terminal

Terms and Conditions at www.hillsdaleterminal.com

HOME



Hillsdale Terminal

Phone: 1-800-447-3150

Email: sales@hillsdaleterminal.com

12-10 A.W.G. Vinyl Rings

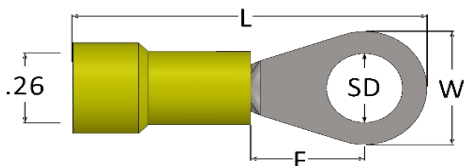

- Terminal I.D. - .141/.144
- 110 Copper Alloy .038 thickness, Electro-Tin Plated .00025"-.0004"
- Rigid PVC Insulator .032 wall thickness

Part #	Stud Size	Barrel Length	Length	W	Stud Diameter(SD)	F	Voltage
50210*	6	.250	1.020	.342	.143/.147	.297	600
50215	6 Slim	.250	1.0	.290	.143/.147	.297	600
50220*	8	.250	1.020	.342	.168/.171	.297	600
50225	8 Slim	.250	1.0	.290	.168/.171	.297	600
50230*	10	.250	1.020	.342	.194/.197	.297	600
50240*	1/4	.250	1.30	.558	.257/.261	.469	600
50245*	1/4 Slim	.250	1.230	.434	.257/.261	.469	600
50250*	5/16	.250	1.30	.558	.327/.323	.469	600
50260*	3/8	.250	1.30	.558	.400/.394	.469	600
50233*	1/2	.250	1.50	.690	.525/.530	.615	600
50235	1/2 Wide	.250	1.560	.760	.518/.522	.620	600
50230M*	6-8-10	.250	1.190	.390	NA	.350	600

All dimensions are in Inches

* =UL and CSA listed

~ =CSA listed

Required per UL/CSA Requirements:

75° C Max. Temperature Rating

One crimp required

Solid or Stranded wire

Crimp tool HT #20593-NH13

Strip Length 9/32" (7.1mm)

Min. Wire Pullout Force	12AWG	70lbs.
	10AWG	80lbs.

Agency and Compliance:

UL Listed, investigated to UL 486 A-B, File NO. ZMVV.E68376

CSA 22.2 No. 65-03, Certification NO. 207131

WARNING! Installation of electrical wire and terminals can be hazardous if done improperly. Improper use can result in personal injury or property damage. For safe wiring practices, consult National Electrical Code and/or your local building inspector. A licensed electrical contractor or engineer must be consulted to determine that the correct wire and terminal size is used and that it is properly and safely installed for all applications.

All statements, procedural information, and recommendations related to Hillsdale Terminal's products are based on data believed to be reliable, but the precision or completeness is not definite. Before using this product, you must evaluate it and determine if it is suitable for your intended application. You accept all risks and liability associated with such use. Any statements related to the product which are not in Hillsdale Terminal's current publications shall have no force or effect unless expressly agreed upon, in writing, by a sanctioned member of Hillsdale Terminal

Terms and Conditions at www.hillsdaleterminal.com

HOME



Hillsdale Terminal

Phone: 1-800-447-3150

Email: sales@hillsdaleterminal.com

8-6 A.W.G Vinyl Rings

Material Thickness:

8 AWG: .042

6 AWG: .050

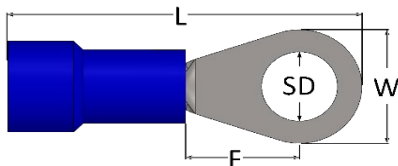

- Alloy 110 Copper with brazed seam. Electro-Tin Plated .00025-.0004 thick

- Rigid PVC insulator

Bell 8 AWG I.D. - .320

Bell 6 AWG I.D. -.410

A.W.G.	Part #	Stud Size	Barrel Length	Length	W	Stud Diameter(SD)	F	Voltage
8	50608	#8	.330	1.25	.375	.173/.175	.358	600
	50609	#8-10 Slim	.330	1.22	.375	.197/.200	.358	600
	50610	#8-10	.330	1.27	.472	.197/.200	.358	600
	50611	#12-1/4	.330	1.27	.472	.262/.265	.358	600
	50612	5/16	.330	1.50	.590	.340/.343	.535	600
	50613	3/8	.330	1.50	.590	.389/.391	.535	600
	50614	1/2	.330	1.66	.780	.515/.520	.620	600
6	50615	#8-10	.375	1.54	.470	.197/.200	.530	600
	50615E	#8-10	.375	1.40	.470	.197/.200	.390	600
	50616	#12-1/4	.375	1.54	.470	.262/.265	.530	600
	50616E	#12-1/4	.375	1.40	.470	.262/.265	.390	600
	50617	5/16	.375	1.62	.620	.325/.328	.530	600
	50618	3/8	.375	1.62	.620	.397/.400	.530	600
	50619	1/2	.375	2.0	.860	.518/.522	.750	600

All dimensions are in Inches

* =UL and CSA listed

~ =CSA listed

Required per UL/CSA Requirements:

75° C Max. Temperature Rating

One crimp required

Solid or Stranded wire

Crimp tool HT #20701 Hex Crimp Jr.

Strip Length 9/32" (7.1mm)

Agency and Compliance:

UL Listed, investigated to UL 486 A-B, File NO. ZMVF.E68376

CSA 22.2 No. 65-03, Certification NO. 207131

Min. Wire Pullout Force	8AWG	90lbs.
	6AWG	100lbs.

WARNING! Installation of electrical wire and terminals can be hazardous if done improperly. Improper use can result in personal injury or property damage. For safe wiring practices, consult National Electrical Code and/or your local building inspector. A licensed electrical contractor or engineer must be consulted to determine that the correct wire and terminal size is used and that it is properly and safely installed for all applications.

All statements, procedural information, and recommendations related to Hillsdale Terminal's products are based on data believed to be reliable, but the precision or completeness is not definite. Before using this product, you must evaluate it and determine if it is suitable for your intended application. You accept all risks and liability associated with such use. Any statements related to the product which are not in Hillsdale Terminal's current publications shall have no force or effect unless expressly agreed upon, in writing, by a sanctioned member of Hillsdale Terminal

Terms and Conditions at www.hillsdaleterminal.com

HOME



Hillsdale Terminal

Phone: 1-800-447-3150

Email: sales@hillsdaleterminal.com

22-18 A.W.G. Nylon Rings

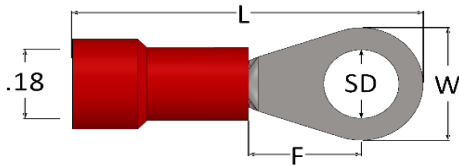

- Terminal I.D. - .078
- 110 Copper Alloy .028 thickness, Electro-Tin Plated .0001"-.0003"
- Nylon Insulator .030 thickness

Part #	Stud Size	Barrel Length	Length	W	Stud Diameter(SD)	F	Voltage
50014N	4	.250	.80	.225	.122/.125	.223	600
50020N*	6	.250	.870	.290	.139/.142	.260	600
50020EN	6	.190	.788	.290	.138/.142	.250	600
50021N	6 Slim	.250	.80	.225	.139/.142	.223	600
50021EN	6 Slim	.190	.718	.225	.138/.142	.223	600
50030N*	8	.250	.880	.324	.168/.171	.250	600
50038N	8 Slim	.250	.880	.290	.168/.171	.260	600
50038EN	8 Slim	.190	.788	.290	.168/.171	.250	600
50040N*	10	.250	.880	.324	.194/.197	.250	600
50040EN	10	.190	.788	.290	.194/.197	.253	600
50041N*	1/4	.250	1.110	.470	.260/.265	.405	600
50044N*	1/4 Slim	.250	1.030	.430	.263/.265	.345	600
50044EN	1/4 Slim	.190	.960	.430	.263/.265	.345	600
50042N*	5/16	.250	1.10	.470	.324/.327	.405	600
50042EN	5/16	.190	.828	.470	.324/.327	.405	600
50043N*	3/8	.250	1.20	.558	.394/.398	.469	600
50040MN*	6-8-10	.250	.960	.340	NA	.345	600

All dimensions are in Inches

* =UL and CSA listed

~ =CSA listed

Required per UL/CSA Requirements:

75° C Max. Temperature Rating

One crimp required

Solid or Stranded wire

Crimp tool HT #20592-NH30

Strip Length 9/32" (7.1mm)

Agency and Compliance:

UL Listed, investigated to UL 486 A-B, File NO. ZMVV.E68376

CSA 22.2 No. 65-03, Certification NO. 207131

Min. Wire Pullout Force	22AWG	8lbs.
	20AWG	13lbs.
	18AWG	20lbs.

WARNING! Installation of electrical wire and terminals can be hazardous if done improperly. Improper use can result in personal injury or property damage. For safe wiring practices, consult National Electrical Code and/or your local building inspector. A licensed electrical contractor or engineer must be consulted to determine that the correct wire and terminal size is used and that it is properly and safely installed for all applications.

All statements, procedural information, and recommendations related to Hillsdale Terminal's products are based on data believed to be reliable, but the precision or completeness is not definite. Before using this product, you must evaluate it and determine if it is suitable for your intended application. You accept all risks and liability associated with such use. Any statements related to the product which are not in Hillsdale Terminal's current publications shall have no force or effect unless expressly agreed upon, in writing, by a sanctioned member of Hillsdale Terminal

Terms and Conditions at www.hillsdaleterminal.com

HOME



Hillsdale Terminal

Phone: 1-800-447-3150

Email: sales@hillsdaleterminal.com

16-14 A.W.G. Nylon Rings

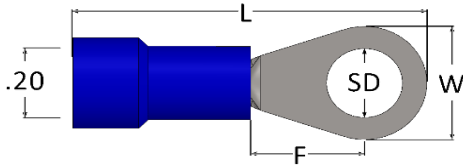

- 110 Copper Alloy .030 thickness, Electro-Tin Plated .0001"-.0003"
- Terminal I.D. - .093

Part #	Stud Size	Barrel Length	Length	W	Stud Diameter(SD)	F	Voltage
50084N	4	.250	.880	.264	.122/.125	.195	600
50086N*	6	.250	.880	.295	.138/.142	.260	600
50086EN	6	.188	.778	.295	.139/.142	.260	600
50085N	6 Slim	.250	.790	.246	.139/.142	.195	600
50090N*	8	.250	.930	.324	.168/.171	.295	600
50098N	8 Slim	.250	.880	.295	.168/.172	.260	600
50098EN	8 Slim	.188	.795	.295	.168/.172	.260	600
50100N*	10	.250	.930	.324	.194/.197	.295	600
50100EN	10	.188	.860	.324	.194/.197	.295	600
50101N*	1/4	.250	1.110	.470	.263/.265	.405	600
50114N*	1/4 Slim	.250	1.030	.430	.263/.265	.345	600
50114EN	1/4 Slim	.188	.970	.430	.263/.265	.345	600
50102N*	5/16	.250	1.110	.470	.324/.327	.405	600
50102EN	5/16	.188	1.050	.470	.324/.327	.405	600
50103N*	3/8	.250	1.210	.558	.394/.398	.569	600
50104N*	1/2	.250	1.430	.430	.525/.530	.615	600
50100MN*	6-8-10	.250	1.020	.340	NA	.345	600

All dimensions are in Inches

* =UL and CSA listed

~ =CSA listed

Required per UL/CSA Requirements:

75° C Max. Temperature Rating

One crimp required

Solid or Stranded wire

Crimp tool HT #20592-NH30

Strip Length 9/32" (7.1mm)

Agency and Compliance:

UL Listed, investigated to UL 486 A-B, File NO. ZMVV.E68376

CSA 22.2 No. 65-03, Certification NO. 207131

Min. Wire Pullout Force	16AWG	30lbs.
	14AWG	50lbs.

WARNING! Installation of electrical wire and terminals can be hazardous if done improperly. Improper use can result in personal injury or property damage. For safe wiring practices, consult National Electrical Code and/or your local building inspector. A licensed electrical contractor or engineer must be consulted to determine that the correct wire and terminal size is used and that it is properly and safely installed for all applications.

All statements, procedural information, and recommendations related to Hillsdale Terminal's products are based on data believed to be reliable, but the precision or completeness is not definite. Before using this product, you must evaluate it and determine if it is suitable for your intended application. You accept all risks and liability associated with such use. Any statements related to the product which are not in Hillsdale Terminal's current publications shall have no force or effect unless expressly agreed upon, in writing, by a sanctioned member of Hillsdale Terminal

Terms and Conditions at www.hillsdaleterminal.com

[HOME](#)



Hillsdale Terminal

Phone: 1-800-447-3150

Email: sales@hillsdaleterminal.com

12-10 A.W.G. Nylon Rings

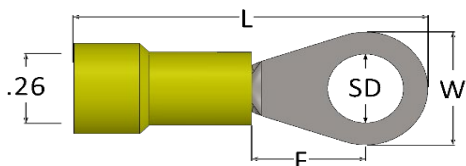

- 110 Copper Alloy .038 thickness, Electro-Tin Plated .00025"-.0004"
- Terminal I.D. - .141/.144

Part #	Stud Size	Barrel Length	Length	W	Stud Diameter(SD)	F	Voltage
50210N*	6	.250	1.020	.342	.143/.147	.297	600
50215N	6 Slim	.250	1.0	.290	.143/.147	.297	600
50220N*	8	.250	1.020	.342	.168/.171	.297	600
50225N	8 Slim	.250	1.0	.290	.168/.171	.297	600
50230N*	10	.250	1.020	.342	.194/.197	.297	600
50240N*	1/4	.250	1.30	.558	.257/.261	.469	600
50245N*	1/4 Slim	.250	1.230	.434	.257/.261	.469	600
50250N*	5/16	.250	1.30	.558	.327/.323	.469	600
50260N*	3/8	.250	1.30	.558	.400/.394	.469	600
50233N*	1/2	.250	1.50	.690	.525/.530	.615	600
50230MN*	6-8-10	.250	1.190	.390	NA	.350	600

All dimensions are in Inches

* =UL and CSA listed

~ =CSA listed

Required per UL/CSA Requirements:

75° C Max. Temperature Rating

One crimp required

Solid or Stranded wire

Crimp tool HT #20593-NH13

Strip Length 9/32" (7.1mm)

Agency and Compliance:

UL Listed, investigated to UL 486 A-B, File NO. ZMVV.E68376

CSA 22.2 No. 65-03, Certification NO. 207131

Min. Wire Pullout Force	12AWG	70lbs.
	10AWG	80lbs.

WARNING! Installation of electrical wire and terminals can be hazardous if done improperly. Improper use can result in personal injury or property damage. For safe wiring practices, consult National Electrical Code and/or your local building inspector. A licensed electrical contractor or engineer must be consulted to determine that the correct wire and terminal size is used and that it is properly and safely installed for all applications.

All statements, procedural information, and recommendations related to Hillsdale Terminal's products are based on data believed to be reliable, but the precision or completeness is not definite. Before using this product, you must evaluate it and determine if it is suitable for your intended application. You accept all risks and liability associated with such use. Any statements related to the product which are not in Hillsdale Terminal's current publications shall have no force or effect unless expressly agreed upon, in writing, by a sanctioned member of Hillsdale Terminal

Terms and Conditions at www.hillsdaleterminal.com

HOME



Hillsdale Terminal

Phone: 1-800-447-3150

Email: sales@hillsdaleterminal.com

8-2 A.W.G Nylon Rings

Material Thickness

8 AWG: .042

6 AWG: .050

4 AWG: .070

2 AWG: .070

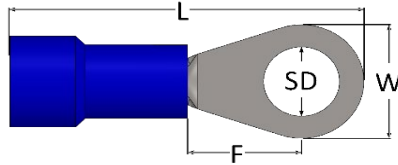

- Alloy 110 Copper with brazed seam. Electro-Tin Plated .00025-.0004 thick
- 8 AWG Insulator I.D. - .320
- 6 AWG Insulator I.D. - .410
- 4 AWG Insulator I.D. - .510
- 2 AWG Insulator I.D. - .590

A.W.G.	Part #	Stud Size	Barrel Length	Length	W	Stud Diameter(SD)	F	Voltage
8	50608N	#8	.330	1.25	.375	.173/.175	.358	600
	50609N	#8-10 Slim	.330	1.22	.375	.197/.200	.358	600
	50610N	#8-10	.330	1.27	.472	.197/.200	.358	600
	50611N	#12-1/4	.330	1.27	.472	.262/.265	.358	600
	50612N	5/16	.330	1.50	.590	.340/.343	.535	600
	50613N	3/8	.330	1.50	.590	.389/.391	.535	600
	50614N	1/2	.330	1.66	.780	.515/.520	.620	600
6	50615N	#8-10	.375	1.54	.470	.197/.200	.530	600
	50615EN	#8-10	.375	1.40	.470	.197/.200	.390	600
	50616N	#12-1/4	.375	1.54	.470	.262/.265	.530	600
	50616EN	#12-1/4	.375	1.40	.470	.262/.265	.390	600
	50617N	5/16	.375	1.62	.620	.325/.328	.530	600
	50618N	3/8	.375	1.62	.620	.397/.400	.530	600
	50619N	1/2	.375	2.00	.860	.518/.522	.750	600
4	50898N	#10 Slim	.467	1.68	.468	.197/.200	.546	600
	50620N	1/4	.470	1.75	.656	.262/.265	.546	600
	50899N	1/4 Slim	.467	1.68	.468	.262/.265	.546	600
	50621N	5/16	.470	1.75	.656	.325/.328	.546	600
	50622N	3/8	.470	1.75	.656	.397/.400	.546	600
	50623N	1/2	.470	2.00	.860	.518/.522	.750	600
2	50628N	1/4	.50	2.05	.625	.262/.265	.710	600
	50629N	5/16	.50	2.05	.625	.325/.328	.710	600
	50630N	3/8	.50	2.05	.625	.397/.400	.710	600
	50631N	1/2	.50	2.10	.860	.518/.522	.710	600

All dimensions are in Inches

* =UL and CSA listed

~ =CSA listed

Required per UL/CSA Requirements:

75° C Max. Temperature Rating

One crimp required

Solid or Stranded wire

Crimp tool HT #20701 Hex Crimp Jr.

Strip Length 15/32"

Agency and Compliance:

UL Listed, investigated to UL 486 A-B, File NO. ZMVV.E68376

CSA 22.2 No. 65-03, Certification NO. 207131

Min. Wire Pullout Force	8AWG	90lbs.
	6AWG	100lbs.
	4AWG	140lbs.
	2AWG	180lbs.

WARNING! Installation of electrical wire and terminals can be hazardous if done improperly. Improper use can result in personal injury or property damage. For safe wiring practices, consult National Electrical Code and/or your local building inspector. A licensed electrical contractor or engineer must be consulted to determine that the correct wire and terminal size is used and that it is properly and safely installed for all applications.

All statements, procedural information, and recommendations related to Hillsdale Terminal's products are based on data believed to be reliable, but the precision or completeness is not definite. Before using this product, you must evaluate it and determine if it is suitable for your intended application. You accept all risks and liability associated with such use. Any statements related to the product which are not in Hillsdale Terminal's current publications shall have no force or effect unless expressly agreed upon, in writing, by a sanctioned member of Hillsdale Terminal

Terms and Conditions at www.hillsdaleterminal.com

[HOME](#)



Hillsdale Terminal

Phone: 1-800-447-3150

Email: sales@hillsdaleterminal.com

22-18 A.W.G. 3-Piece Rings

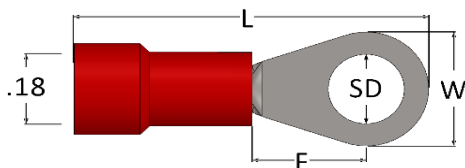

- 110 Copper Alloy .028 thickness, Electro-Tin Plated .0001"-.0003"
- Terminal I.D. - .078
- Brass Sleeve

Part #	Stud Size	Barrel Length	Length	W	Stud Diameter(SD)	F	Voltage
30014	4	.250	.790	.225	.122/.125	.223	600
30020	6	.250	.850	.290	.139/.142	.260	600
30021	6 Slim	.250	.80	.225	.139/.142	.223	600
30030	8	.250	.870	.324	.168/.171	.250	600
30038	8 Slim	.250	.870	.290	.168/.171	.260	600
30040	10	.250	.870	.324	.194/.197	.250	600
30041	1/4	.250	1.110	.470	.260/.265	.405	600
30044	1/4 Slim	.250	1.010	.430	.263/.265	.345	600
30042	5/16	.250	1.110	.470	.324/.327	.405	600
30043	3/8	.250	1.20	.558	.394/.398	.469	600
30040M	6-8-10	.250	.960	.340	NA	.345	600

All dimensions are in Inches

* =UL and CSA listed

~ =CSA listed

Required per UL/CSA Requirements:

75° C Max. Temperature Rating

One crimp required

Solid or Stranded wire

Crimp tool HT #20592-NH30

Strip Length 9/32" (7.1mm)

Agency and Compliance:

UL Listed, investigated to UL 486 A-B, File NO. ZMVV.E68376

CSA 22.2 No. 65-03, Certification NO. 207131

Min. Wire Pullout Force	22AWG	8lbs.
	20AWG	13lbs.
	18AWG	20lbs.

WARNING! Installation of electrical wire and terminals can be hazardous if done improperly. Improper use can result in personal injury or property damage. For safe wiring practices, consult National Electrical Code and/or your local building inspector. A licensed electrical contractor or engineer must be consulted to determine that the correct wire and terminal size is used and that it is properly and safely installed for all applications.

All statements, procedural information, and recommendations related to Hillsdale Terminal's products are based on data believed to be reliable, but the precision or completeness is not definite. Before using this product, you must evaluate it and determine if it is suitable for your intended application. You accept all risks and liability associated with such use. Any statements related to the product which are not in Hillsdale Terminal's current publications shall have no force or effect unless expressly agreed upon, in writing, by a sanctioned member of Hillsdale Terminal

Terms and Conditions at www.hillsdaleterminal.com





Hillsdale Terminal

Phone: 1-800-447-3150

Email: sales@hillsdaleterminal.com

16-14 A.W.G. 3-Piece Rings

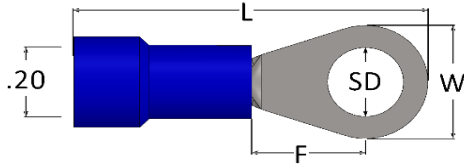

- 110 Copper Alloy .030 thickness, Electro-Tin Plated .0001"-.0003"
- Terminal I.D. - .093
- Brass Sleeve

Part #	Stud Size	Barrel Length	Length	W	Stud Diameter(SD)	F	Voltage
30084	4	.250	.880	.264	.122/.125	.195	600
30086	6	.250	.860	.295	.138/.142	.260	600
30085	6 Slim	.250	.770	.246	.139/.142	.195	600
30090	8	.250	.910	.324	.168/.171	.295	600
30098	8 Slim	.250	.880	.295	.168/.172	.260	600
30100	10	.250	.910	.324	.194/.197	.295	600
30101	1/4	.250	1.10	.470	.263/.265	.405	600
30114	1/4 Slim	.250	1.020	.430	.263/.265	.345	600
30102	5/16	.250	1.110	.470	.324/.327	.405	600
30103	3/8	.250	1.20	.558	.394/.398	.569	600
30104	1/2	.250	1.420	.430	.525/.530	.615	600
30100M	6-8-10	.250	1.020	.340	NA	.345	600

All dimensions are in Inches

* =UL and CSA listed

~ =CSA listed

Required per UL/CSA Requirements:

75° C Max. Temperature Rating

One crimp required

Solid or Stranded wire

Crimp tool HT #20592-NH30

Strip Length 9/32" (7.1mm)

Min. Wire Pullout Force	16AWG	30lbs.
	14AWG	50lbs.

Agency and Compliance:

UL Listed, investigated to UL 486 A-B, File NO. ZMVV.E68376

CSA 22.2 No. 65-03, Certification NO. 207131

WARNING! Installation of electrical wire and terminals can be hazardous if done improperly. Improper use can result in personal injury or property damage. For safe wiring practices, consult National Electrical Code and/or your local building inspector. A licensed electrical contractor or engineer must be consulted to determine that the correct wire and terminal size is used and that it is properly and safely installed for all applications.

All statements, procedural information, and recommendations related to Hillsdale Terminal's products are based on data believed to be reliable, but the precision or completeness is not definite. Before using this product, you must evaluate it and determine if it is suitable for your intended application. You accept all risks and liability associated with such use. Any statements related to the product which are not in Hillsdale Terminal's current publications shall have no force or effect unless expressly agreed upon, in writing, by a sanctioned member of Hillsdale Terminal

Terms and Conditions at www.hillsdaleterminal.com

[HOME](#)



Hillsdale Terminal

Phone: 1-800-447-3150

Email: sales@hillsdaleterminal.com

12-10 A.W.G. 3-Piece Rings

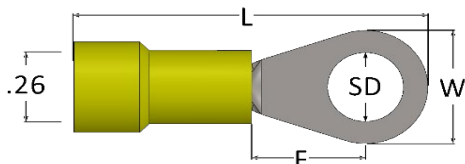

- 110 Copper Alloy .038 thickness, Electro-Tin Plated .00025"-.0004"
- Terminal I.D. - .141/.144
- Brass Sleeve

Part #	Stud Size	Barrel Length	Length	W	Stud Diameter(SD)	F	Voltage
30210	6	.250	1.030	.342	.143/.147	.297	600
30215	6 Slim	.250	1.0	.290	.143/.147	.297	600
30220	8	.250	1.030	.342	.168/.171	.297	600
30225	8 Slim	.250	1.0	.290	.168/.171	.297	600
30230	10	.250	1.030	.342	.194/.197	.297	600
30240	1/4	.250	1.310	.558	.257/.261	.469	600
30245	1/4 Slim	.250	1.230	.434	.257/.261	.469	600
30250	5/16	.250	1.30	.558	.327/.323	.469	600
30260	3/8	.250	1.310	.558	.400/.394	.469	600
30233	1/2	.250	1.510	.690	.525/.530	.615	600
30235	1/2 Wide	.250	1.550	.760	.518/.522	.620	600
30230M	6-8-10	.250	1.190	.390	NA	.350	600

All dimensions are in Inches

* =UL and CSA listed

~ =CSA listed

Required per UL/CSA Requirements:

75° C Max. Temperature Rating

One crimp required

Solid or Stranded wire

Crimp tool HT #20593-NH13

Strip Length 9/32" (7.1mm)

Min. Wire Pullout Force	12AWG	70lbs.
	10AWG	80lbs.

Agency and Compliance:

UL Listed, investigated to UL 486 A-B, File NO. ZMVV.E68376

CSA 22.2 No. 65-03, Certification NO. 207131

WARNING! Installation of electrical wire and terminals can be hazardous if done improperly. Improper use can result in personal injury or property damage. For safe wiring practices, consult National Electrical Code and/or your local building inspector. A licensed electrical contractor or engineer must be consulted to determine that the correct wire and terminal size is used and that it is properly and safely installed for all applications.

All statements, procedural information, and recommendations related to Hillsdale Terminal's products are based on data believed to be reliable, but the precision or completeness is not definite. Before using this product, you must evaluate it and determine if it is suitable for your intended application. You accept all risks and liability associated with such use. Any statements related to the product which are not in Hillsdale Terminal's current publications shall have no force or effect unless expressly agreed upon, in writing, by a sanctioned member of Hillsdale Terminal

Terms and Conditions at www.hillsdaleterminal.com

HOME



Hillsdale Terminal

Phone: 1-800-447-3150

Email: sales@hillsdaleterminal.com

22-18 A.W.G. Heat Shrink Rings

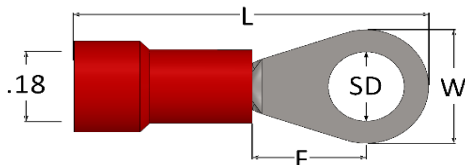

- 110 Copper Alloy .028 thickness, Electro-Tin Plated .0001"-.0003"
- Terminal I.D. - .078
- L suffix denotes long neck terminals

Part #	Stud Size	Barrel Length	Length	W	Stud Diameter(SD)	F	Voltage
40014	4	.250	1.090	.225	.122/.125	.223	600
40020	6	.250	1.180	.290	.139/.142	.260	600
40021	6 Slim	.250	1.090	.225	.139/.142	.223	600
40030	8	.250	1.180	.324	.168/.171	.250	600
40030L	8	.250	1.340	.324	.168/.171	.405	600
40038	8 Slim	.250	1.180	.290	.168/.171	.260	600
40040	10	.250	1.180	.324	.194/.197	.250	600
40040L	10	.250	1.340	.324	.194/.197	.405	600
40041	1/4	.250	1.190	.470	.260/.265	.405	600
40044	1/4 Slim	.250	1.310	.430	.263/.265	.345	600
40042	5/16	.250	1.390	.470	.324/.327	.405	600
40043	3/8	.250	1.490	.558	.394/.398	.469	600
40040M	6-8-10	.250	1.330	.340	NA	.345	600

All dimensions are in Inches

* =UL and CSA listed

~ =CSA listed

Required per UL/CSA Requirements:

75° C Max. Temperature Rating

One crimp required

Solid or Stranded wire

Crimp tool HT #20596

Strip Length 9/32" (7.1mm)

Agency and Compliance:

UL Listed, investigated to UL 486 A-B, File NO. ZMVV.E68376

CSA 22.2 No. 65-03, Certification NO. 207131

Min. Wire Pullout Force	22AWG	8lbs.
	20AWG	13lbs.
	18AWG	20lbs.

WARNING! Installation of electrical wire and terminals can be hazardous if done improperly. Improper use can result in personal injury or property damage. For safe wiring practices, consult National Electrical Code and/or your local building inspector. A licensed electrical contractor or engineer must be consulted to determine that the correct wire and terminal size is used and that it is properly and safely installed for all applications.

All statements, procedural information, and recommendations related to Hillsdale Terminal's products are based on data believed to be reliable, but the precision or completeness is not definite. Before using this product, you must evaluate it and determine if it is suitable for your intended application. You accept all risks and liability associated with such use. Any statements related to the product which are not in Hillsdale Terminal's current publications shall have no force or effect unless expressly agreed upon, in writing, by a sanctioned member of Hillsdale Terminal

Terms and Conditions at www.hillsdaleterminal.com





Hillsdale Terminal

Phone: 1-800-447-3150

Email: sales@hillsdaleterminal.com

16-14 A.W.G. Heat Shrink Rings

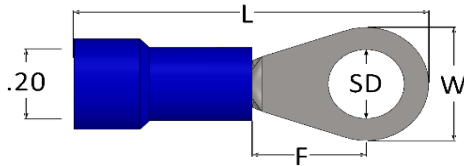

- 110 Copper Alloy .030 thickness, Electro-Tin Plated .0001"-.0003"
- Terminal I.D. - .093
- L suffix denotes long neck terminals

Part #	Stud Size	Barrel Length	Length	W	Stud Diameter(SD)	F	Voltage
40084	4	.250	1.070	.264	.122/.125	.195	600
40086	6	.250	1.160	.295	.138/.142	.260	600
40085	6 Slim	.250	1.070	.246	.139/.142	.195	600
40090	8	.250	1.210	.324	.168/.171	.295	600
40090L	8	.250	1.320	.324	.168/.171	.405	600
40098	8 Slim	.250	1.150	.295	.168/.172	.260	600
40100	10	.250	1.210	.324	.194/.197	.295	600
40100L	10	.250	1.320	.324	.194/.197	.405	600
40101	1/4	.250	1.390	.470	.263/.265	.405	600
40114	1/4 Slim	.250	1.310	.430	.263/.265	.345	600
40102	5/16	.250	1.390	.470	.324/.327	.405	600
40103	3/8	.250	1.490	.558	.394/.398	.569	600
40104	1/2	.250	1.710	.430	.525/.530	.615	600
40100M	6-8-10	.250	1.330	.340	NA	.345	600

All dimensions are in Inches

* =UL and CSA listed

~ =CSA listed

Required per UL/CSA Requirements:

75° C Max. Temperature Rating

One crimp required

Solid or Stranded wire

Crimp tool HT #20596

Strip Length 9/32" (7.1mm)

Min. Wire Pullout Force	16AWG	30lbs.
	14AWG	50lbs.

Agency and Compliance:

UL Listed, investigated to UL 486 A-B, File NO. ZMVV.E68376

CSA 22.2 No. 65-03, Certification NO. 207131

WARNING! Installation of electrical wire and terminals can be hazardous if done improperly. Improper use can result in personal injury or property damage. For safe wiring practices, consult National Electrical Code and/or your local building inspector. A licensed electrical contractor or engineer must be consulted to determine that the correct wire and terminal size is used and that it is properly and safely installed for all applications.

All statements, procedural information, and recommendations related to Hillsdale Terminal's products are based on data believed to be reliable, but the precision or completeness is not definite. Before using this product, you must evaluate it and determine if it is suitable for your intended application. You accept all risks and liability associated with such use. Any statements related to the product which are not in Hillsdale Terminal's current publications shall have no force or effect unless expressly agreed upon, in writing, by a sanctioned member of Hillsdale Terminal

Terms and Conditions at www.hillsdaleterminal.com

HOME



Hillsdale Terminal

Phone: 1-800-447-3150

Email: sales@hillsdaleterminal.com

12-10 A.W.G. Heat Shrink Rings

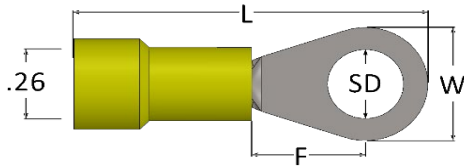

- 110 Copper Alloy .038 thickness, Electro-Tin Plated .00025"-.0004"
- Terminal I.D. - .141/.144
- L suffix denotes long neck terminals

Part #	Stud Size	Barrel Length	Length	W	Stud Diameter(SD)	F	Voltage
40210	6	.250	1.150	.342	.143/.147	.297	600
40215	6 Slim	.250	1.150	.290	.143/.147	.297	600
40220	8	.250	1.150	.342	.168/.171	.297	600
40225	8 Slim	.250	1.250	.290	.168/.171	.297	600
40230	10	.250	1.150	.342	.194/.197	.297	600
40230L	10	.250	1.440	.434	.194/.197	.469	600
40240	1/4	.250	1.450	.558	.257/.261	.469	600
40245	1/4 Slim	.250	1.490	.434	.257/.261	.469	600
40250	5/16	.250	1.550	.558	.327/.323	.469	600
40260	3/8	.250	1.450	.558	.400/.394	.469	600
40233	1/2	.250	1.690	.690	.525/.530	.615	600
40230M	6-8-10	.250	1.390	.390	NA	.350	600

All dimensions are in Inches

* =UL and CSA listed

~ =CSA listed

Required per UL/CSA Requirements:

75° C Max. Temperature Rating

One crimp required

Solid or Stranded wire

Crimp tool HT #20596

Strip Length 9/32" (7.1mm)

Agency and Compliance:

UL Listed, investigated to UL 486 A-B, File NO. ZMVV.E68376

CSA 22.2 No. 65-03, Certification NO. 207131

Min. Wire Pullout Force	12AWG	70lbs.
	10AWG	80lbs.

WARNING! Installation of electrical wire and terminals can be hazardous if done improperly. Improper use can result in personal injury or property damage. For safe wiring practices, consult National Electrical Code and/or your local building inspector. A licensed electrical contractor or engineer must be consulted to determine that the correct wire and terminal size is used and that it is properly and safely installed for all applications.

All statements, procedural information, and recommendations related to Hillsdale Terminal's products are based on data believed to be reliable, but the precision or completeness is not definite. Before using this product, you must evaluate it and determine if it is suitable for your intended application. You accept all risks and liability associated with such use. Any statements related to the product which are not in Hillsdale Terminal's current publications shall have no force or effect unless expressly agreed upon, in writing, by a sanctioned member of Hillsdale Terminal

Terms and Conditions at www.hillsdaleterminal.com

[HOME](#)



Hillsdale Terminal

Phone: 1-800-447-3150

Email: sales@hillsdaleterminal.com

8 A.W.G. Heat Shrink Rings

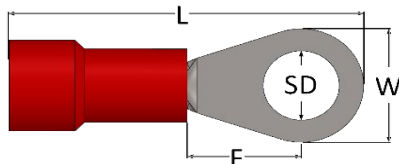

- 110 Copper Alloy .042 thickness, Electro-Tin Plated .0001"-.0003"
- Terminal I.D. .18

Part #	Stud Size	Barrel Length	Length	W	Stud Diameter(SD)	F	Voltage
40608	8	.330	1.50	.375	.173/.175	.358	600
40609	10 Slim	.330	1.47	.375	.197/.200	.358	600
40610	10	.330	1.52	.472	.197/.200	.358	600
40611	1/4	.330	1.52	.472	.262/.265	.358	600
40612	5/16	.330	1.75	.590	.340/.343	.535	600
40613	3/8	.330	1.75	.590	.389/.391	.535	600
40614	1/2	.330	1.91	.780	.515/.520	.620	600

All dimensions are in Inches

* =UL and CSA listed

~ =CSA listed

Required per UL/CSA Requirements:

75° C Max. Temperature Rating

One crimp required

Solid or Stranded wire

Crimp tool HT #20701 Hex Crimp Jr.

Strip Length 9/32" (7.1mm)

Min. Wire Pullout Force	8AWG	90lbs.
-------------------------	------	--------

Agency and Compliance:

UL Listed, investigated to UL 486 A-B, File NO. ZMVV.E68376

CSA 22.2 No. 65-03, Certification NO. 207131

WARNING! Installation of electrical wire and terminals can be hazardous if done improperly. Improper use can result in personal injury or property damage. For safe wiring practices, consult National Electrical Code and/or your local building inspector. A licensed electrical contractor or engineer must be consulted to determine that the correct wire and terminal size is used and that it is properly and safely installed for all applications.

All statements, procedural information, and recommendations related to Hillsdale Terminal's products are based on data believed to be reliable, but the precision or completeness is not definite. Before using this product, you must evaluate it and determine if it is suitable for your intended application. You accept all risks and liability associated with such use. Any statements related to the product which are not in Hillsdale Terminal's current publications shall have no force or effect unless expressly agreed upon, in writing, by a sanctioned member of Hillsdale Terminal

Terms and Conditions at www.hillsdaleterminal.com

[HOME](#)



Hillsdale Terminal

Phone: 1-800-447-3150

Email: sales@hillsdaleterminal.com

22-18 A.W.G. Uninsulated Spades

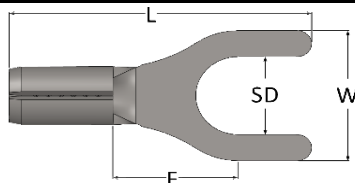

- 110 Copper Alloy .028 thickness, Electro-Tin Plated .0001"-.0003"
- Terminal I.D. - .078

Part #	Stud Size	Barrel Length	Length	W	Stud Diameter(SD)	F	Voltage
10050*	#6	.250	.730	.250	.149	.321	600
10051*	#6 Snap	.250	.730	.250	.149	.321	600
10052*	#6 Block	.250	.730	.250	.149	.321	600
10054	#4	.250	.670	.250	.125	.289	600
10055	#6 Short	.250	.670	.250	.145	.321	600
10056	#6 Block Wide	.250	.730	.30	.149	.321	600
10060*	#8	.250	.730	.312	.175	.321	600
10061*	#8 Snap	.250	.730	.312	.175	.321	600
10062*	#8 Block	.250	.730	.312	.175	.321	600
10068	#8 Slim	.250	.730	.268	.175	.321	600
10070*	#10	.250	.730	.312	.203	.321	600
10071*	#10 Snap	.250	.730	.312	.203	.321	600
10072*	#10 Block	.250	.730	.312	.203	.321	600
10075	1/4	.250	.990	.470	.260	.469	600

All dimensions are in Inches

* =UL and CSA listed

~ =CSA listed

Required per UL/CSA Requirements:

75° C Max. Temperature Rating

One crimp required

Solid or Stranded wire

Crimp tool HT #20591-NH1

Strip Length 1/4" (6.4mm)

Agency and Compliance:

UL Listed, investigated to UL 486 A-B, File NO. ZMVV.E68376

CSA 22.2 No. 65-03, Certification NO. 207131

Min. Wire Pullout Force	22AWG	8lbs.
	20AWG	13lbs.
	18AWG	20lbs.

WARNING! Installation of electrical wire and terminals can be hazardous if done improperly. Improper use can result in personal injury or property damage. For safe wiring practices, consult National Electrical Code and/or your local building inspector. A licensed electrical contractor or engineer must be consulted to determine that the correct wire and terminal size is used and that it is properly and safely installed for all applications.

All statements, procedural information, and recommendations related to Hillsdale Terminal's products are based on data believed to be reliable, but the precision or completeness is not definite. Before using this product, you must evaluate it and determine if it is suitable for your intended application. You accept all risks and liability associated with such use. Any statements related to the product which are not in Hillsdale Terminal's current publications shall have no force or effect unless expressly agreed upon, in writing, by a sanctioned member of Hillsdale Terminal

Terms and Conditions at www.hillsdaleterminal.com

HCME



Hillsdale Terminal

Phone: 1-800-447-3150

Email: sales@hillsdaleterminal.com

16-14 A.W.G. Uninsulated Spades

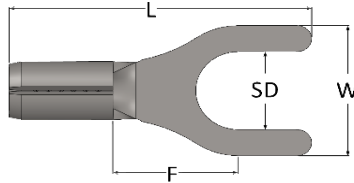

- 110 Copper Alloy .030 thickness, Electro-Tin Plated .0001"-.0003"
- Terminal I.D. - .093

Part #	Stud Size	Barrel Length	Length	W	Stud Diameter(SD)	F	Voltage
10140*	#6	.250	.710	.250	.150	.303	600
10141*	#6 Snap	.250	.710	.250	.150	.303	600
10142*	#6 Block	.250	.710	.250	.150	.303	600
10144	#4 Block	.250	.670	.250	.125	.250	600
10146	#6 Wide Block	.250	.730	.30	.149	.303	600
10150*	#8	.250	.730	.344	.175	.303	600
10151*	#8 Snap	.250	.730	.30	.175	.303	600
10152*	#8 Block	.250	.730	.30	.175	.303	600
10158	#8 Slim Block	.250	.710	.260	.175	.303	600
10160*	#10	.250	.730	.344	.205	.303	600
10161*	#10 Snap	.250	.730	.320	.205	.303	600
10162*	#10 Block	.250	.730	.320	.205	.303	600
10165*	1/4	.250	.990	.470	.260	.469	600

All dimensions are in Inches

* =UL and CSA listed

~ =CSA listed

Required per UL/CSA Requirements:

75° C Max. Temperature Rating

One crimp required

Solid or Stranded wire

Crimp tool HT #20591-NH1

Strip Length 1/4" (6.4mm)

Agency and Compliance:

UL Listed, investigated to UL 486 A-B, File NO. ZMVV.E68376

CSA 22.2 No. 65-03, Certification NO. 207131

Min. Wire Pullout Force	16AWG	30lbs.
	14AWG	50lbs.

WARNING! Installation of electrical wire and terminals can be hazardous if done improperly. Improper use can result in personal injury or property damage. For safe wiring practices, consult National Electrical Code and/or your local building inspector. A licensed electrical contractor or engineer must be consulted to determine that the correct wire and terminal size is used and that it is properly and safely installed for all applications.

All statements, procedural information, and recommendations related to Hillsdale Terminal's products are based on data believed to be reliable, but the precision or completeness is not definite. Before using this product, you must evaluate it and determine if it is suitable for your intended application. You accept all risks and liability associated with such use. Any statements related to the product which are not in Hillsdale Terminal's current publications shall have no force or effect unless expressly agreed upon, in writing, by a sanctioned member of Hillsdale Terminal

Terms and Conditions at www.hillsdaleterminal.com

[HOME](#)



Hillsdale Terminal

Phone: 1-800-447-3150

Email: sales@hillsdaleterminal.com

12-10 A.W.G. Uninsulated Spades

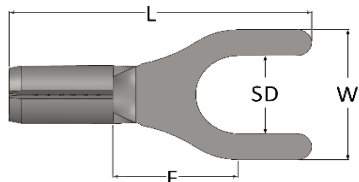

- 110 Copper Alloy .038 thickness, Electro-Tin Plated .00025"-.0004"
- Terminal I.D. - .141/.144

Part #	Stud Size	Barrel Length	Length	W	Stud Diameter(SD)	F	Voltage
10234	1/4	.250	.990	.470	.260	.469	600
10241	1/4 Snap	.250	.990	.470	.212	.469	600
10270*	#6	.250	.720	.350	.149	.294	600
10271*	#6 Snap	.250	.720	.296	.149	.294	600
10272*	#6 Block	.250	.720	.296	.149	.294	600
10280*	#8	.250	.720	.350	.175	.294	600
10281*	#8 Snap	.250	.720	.325	.175	.294	600
10282*	#8 Block	.250	.720	.325	.175	.294	600
10290*	#10	.250	.720	.370	.203	.294	600
10291*	#10 Snap	.250	.720	.350	.203	.294	600
10292*	#10 Block	.250	.720	.350	.203	.294	600

All dimensions are in Inches

* =UL and CSA listed

~ =CSA listed

Required per UL/CSA Requirements:

75° C Max. Temperature Rating

One crimp required

Solid or Stranded wire

Crimp tool HT #20591-NH1

Strip Length 1/4" (6.4mm)

Agency and Compliance:

UL Listed, investigated to UL 486 A-B, File NO. ZMVV.E68376

CSA 22.2 No. 65-03, Certification NO. 207131

Min. Wire Pullout Force	12AWG	70lbs.
	10AWG	80lbs.

WARNING! Installation of electrical wire and terminals can be hazardous if done improperly. Improper use can result in personal injury or property damage. For safe wiring practices, consult National Electrical Code and/or your local building inspector. A licensed electrical contractor or engineer must be consulted to determine that the correct wire and terminal size is used and that it is properly and safely installed for all applications.

All statements, procedural information, and recommendations related to Hillsdale Terminal's products are based on data believed to be reliable, but the precision or completeness is not definite. Before using this product, you must evaluate it and determine if it is suitable for your intended application. You accept all risks and liability associated with such use. Any statements related to the product which are not in Hillsdale Terminal's current publications shall have no force or effect unless expressly agreed upon, in writing, by a sanctioned member of Hillsdale Terminal

Terms and Conditions at www.hillsdaleterminal.com

HOME



Hillsdale Terminal

Phone: 1-800-447-3150

Email: sales@hillsdaleterminal.com

8-6 A.W.G Uninsulated Spades

Material Thickness:

8 AWG: .042

6 AWG: .050

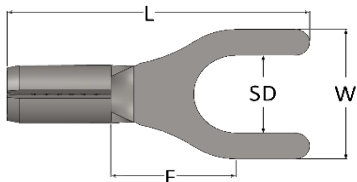

- Alloy 110 Copper with brazed seam.
- Electro-Tin Plated .00025-.0004 thick

A.W.G.	Part #	Stud Size	Barrel Length	Length	W	Stud Diameter(SD)	F	Voltage
8	10607	#10	.330	0.94	.360	.200	.358	600
8	10606	1/4	.330	0.94	.472	.260	.358	600
6	10726	1/4	.413	1.00	.433	.252	.421	600

All dimensions are in Inches

* =UL and CSA listed

~ =CSA listed

Instructions:

75° C Max. Temperature Rating

One crimp required

Solid or Stranded wire

Crimp tool HT #20701

Strip Length 9/32" (7.1mm)

Min. Wire Pullout Force	8AWG	90lbs.
	6AWG	100lbs.

WARNING! Installation of electrical wire and terminals can be hazardous if done improperly. Improper use can result in personal injury or property damage. For safe wiring practices, consult National Electrical Code and/or your local building inspector. A licensed electrical contractor or engineer must be consulted to determine that the correct wire and terminal size is used and that it is properly and safely installed for all applications.

All statements, procedural information, and recommendations related to Hillsdale Terminal's products are based on data believed to be reliable, but the precision or completeness is not definite. Before using this product, you must evaluate it and determine if it is suitable for your intended application. You accept all risks and liability associated with such use. Any statements related to the product which are not in Hillsdale Terminal's current publications shall have no force or effect unless expressly agreed upon, in writing, by a sanctioned member of Hillsdale Terminal

Terms and Conditions at www.hillsdaleterminal.com

HOME



Hillsdale Terminal

Phone: 1-800-447-3150

Email: sales@hillsdaleterminal.com

22-18 A.W.G. High Temp Spades

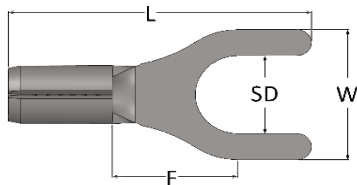

- 1008 Alloy steel. .028 thickness Nickel Plated for 900°F rating
- Terminal I.D. - .078

Part #	Stud Size	Barrel Length	Length	W	Stud Diameter(SD)	F	Voltage
10050HT	#6	.250	.730	.250	.149	.321	600
10060HT	#8	.250	.730	.312	.175	.321	600
10070HT	#10	.250	.730	.312	.203	.321	600

All dimensions are in Inches

* =UL and CSA listed

~ =CSA listed

Instructions:

482° C Max. Temperature Rating

One crimp required

Solid or Stranded wire

Crimp tool HT #2059-NH1

Strip Length 1/4" (6.4mm)

Min. Wire Pullout Force	22AWG	8lbs.
	20AWG	13lbs.
	18AWG	20lbs.

WARNING! Installation of electrical wire and terminals can be hazardous if done improperly. Improper use can result in personal injury or property damage. For safe wiring practices, consult National Electrical Code and/or your local building inspector. A licensed electrical contractor or engineer must be consulted to determine that the correct wire and terminal size is used and that it is properly and safely installed for all applications.

All statements, procedural information, and recommendations related to Hillsdale Terminal's products are based on data believed to be reliable, but the precision or completeness is not definite. Before using this product, you must evaluate it and determine if it is suitable for your intended application. You accept all risks and liability associated with such use. Any statements related to the product which are not in Hillsdale Terminal's current publications shall have no force or effect unless expressly agreed upon, in writing, by a sanctioned member of Hillsdale Terminal

Terms and Conditions at www.hillsdaleterminal.com





Hillsdale Terminal

Phone: 1-800-447-3150

Email: sales@hillsdaleterminal.com

16-14 A.W.G. High Temp Spades

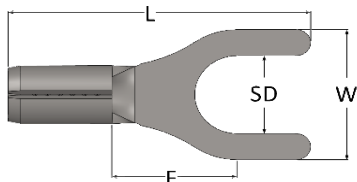

- 1008 Alloy steel. Nickel Plated for 900°F rating
- Terminal I.D. - .093

Part #	Stud Size	Barrel Length	Length	W	Stud Diameter(SD)	F	Voltage
10140HT	#6	.250	.710	.250	.150	.303	600
10150HT	#8	.250	.730	.344	.175	.303	600
10152HT	#8 Block	.250	.730	.30	.175	.303	600
10160HT	#10	.250	.730	.344	.205	.303	600

All dimensions are in Inches

* =UL and CSA listed

~ =CSA listed

Instructions:

482° C Max. Temperature Rating

One crimp required

Solid or Stranded wire

Crimp tool HT #20591-NH1

Strip Length 1/4" (6.4mm)

Min. Wire Pullout Force	16AWG	30lbs.
	14AWG	50lbs.

WARNING! Installation of electrical wire and terminals can be hazardous if done improperly. Improper use can result in personal injury or property damage. For safe wiring practices, consult National Electrical Code and/or your local building inspector. A licensed electrical contractor or engineer must be consulted to determine that the correct wire and terminal size is used and that it is properly and safely installed for all applications.

All statements, procedural information, and recommendations related to Hillsdale Terminal's products are based on data believed to be reliable, but the precision or completeness is not definite. Before using this product, you must evaluate it and determine if it is suitable for your intended application. You accept all risks and liability associated with such use. Any statements related to the product which are not in Hillsdale Terminal's current publications shall have no force or effect unless expressly agreed upon, in writing, by a sanctioned member of Hillsdale Terminal

Terms and Conditions at www.hillsdaleterminal.com

[HOME](#)



Hillsdale Terminal

Phone: 1-800-447-3150

Email: sales@hillsdaleterminal.com

12-10 A.W.G. High Temp Spades

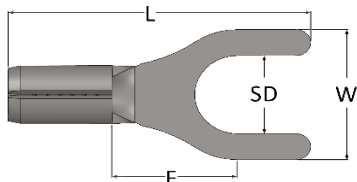

- 1008 Alloy steel. Nickel Plated for 900°F rating
- Terminal I.D. - .141/.144

Part #	Stud Size	Barrel Length	Length	W	Stud Diameter(SD)	F	Voltage
10234HT	1/4	.250	.990	.470	.260	.469	600
10270HT	#6	.250	.720	.350	.149	.294	600
10280HT	#8	.250	.720	.350	.175	.294	600
10290HT	#10	.250	.720	.370	.203	.294	600
10292HT	#10 Block	.250	.720	.350	.203	.294	600

All dimensions are in Inches

* =UL and CSA listed

~ =CSA listed

Instructions

482° C Max. Temperature Rating

One crimp required

Solid or Stranded wire

Crimp tool HT #20591-NH1

Strip Length 1/4" (6.4mm)

Min. Wire Pullout Force	12AWG	70lbs.
	10AWG	80lbs.

WARNING! Installation of electrical wire and terminals can be hazardous if done improperly. Improper use can result in personal injury or property damage. For safe wiring practices, consult National Electrical Code and/or your local building inspector. A licensed electrical contractor or engineer must be consulted to determine that the correct wire and terminal size is used and that it is properly and safely installed for all applications.

All statements, procedural information, and recommendations related to Hillsdale Terminal's products are based on data believed to be reliable, but the precision or completeness is not definite. Before using this product, you must evaluate it and determine if it is suitable for your intended application. You accept all risks and liability associated with such use. Any statements related to the product which are not in Hillsdale Terminal's current publications shall have no force or effect unless expressly agreed upon, in writing, by a sanctioned member of Hillsdale Terminal

Terms and Conditions at www.hillsdaleterminal.com

[HOME](#)



Hillsdale Terminal

Phone: 1-800-447-3150

Email: sales@hillsdaleterminal.com

22-18 A.W.G. Brazed Spades

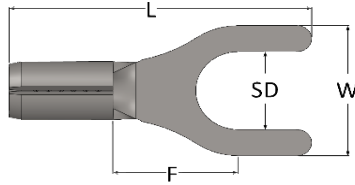

- 110 Copper Alloy .028 thickness, Electro-Tin Plated .0001"-.0003"
- Terminal I.D. - .078

Part #	Stud Size	Barrel Length	Length	W	Stud Diameter(SD)	F	Voltage
10050BZ*	#6	.250	.730	.250	.149	.321	600
10051BZ*	#6 Snap	.250	.730	.250	.149	.321	600
10052BZ*	#6 Block	.250	.730	.250	.149	.321	600
10054BZ	#4	.250	.670	.250	.125	.289	600
10055BZ	#6 Short	.250	.670	.250	.145	.321	600
10056BZ	#6 Block Wide	.250	.730	.30	.149	.321	600
10060BZ*	#8	.250	.730	.312	.175	.321	600
10061BZ*	#8 Snap	.250	.730	.312	.175	.321	600
10062BZ*	#8 Block	.250	.730	.312	.175	.321	600
10068BZ	#8 Slim	.250	.730	.268	.175	.321	600
10070BZ*	#10	.250	.730	.312	.203	.321	600
10071BZ*	#10 Snap	.250	.730	.312	.203	.321	600
10072BZ*	#10 Block	.250	.730	.312	.203	.321	600
10075BZ	1/4	.250	.990	.470	.260	.469	600

All dimensions are in Inches

* =UL and CSA listed

~ =CSA listed

Required per UL/CSA Requirements:

75° C Max. Temperature Rating

One crimp required

Solid or Stranded wire

Crimp tool HT #20591-NH1

Strip Length 1/4" (6.4mm)

Agency and Compliance:

UL Listed, investigated to UL 486 A-B, File NO. ZMVV.E68376

CSA 22.2 No. 65-03, Certification NO. 207131

Min. Wire Pullout Force	22AWG	8lbs.
	20AWG	13lbs.
	18AWG	20lbs.

WARNING! Installation of electrical wire and terminals can be hazardous if done improperly. Improper use can result in personal injury or property damage. For safe wiring practices, consult National Electrical Code and/or your local building inspector. A licensed electrical contractor or engineer must be consulted to determine that the correct wire and terminal size is used and that it is properly and safely installed for all applications.

All statements, procedural information, and recommendations related to Hillsdale Terminal's products are based on data believed to be reliable, but the precision or completeness is not definite. Before using this product, you must evaluate it and determine if it is suitable for your intended application. You accept all risks and liability associated with such use. Any statements related to the product which are not in Hillsdale Terminal's current publications shall have no force or effect unless expressly agreed upon, in writing, by a sanctioned member of Hillsdale Terminal

Terms and Conditions at www.hillsdaleterminal.com





Hillsdale Terminal

Phone: 1-800-447-3150

Email: sales@hillsdaleterminal.com

16-14 A.W.G. Brazed Spades

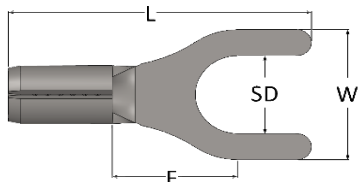

- 110 Copper Alloy .030 thickness, Electro-Tin Plated .0001"-.0003"
- Terminal I.D. - .093

Part #	Stud Size	Barrel Length	Length	W	Stud Diameter(SD)	F	Voltage
10140BZ*	#6	.250	.710	.250	.150	.303	600
10141BZ*	#6 Snap	.250	.710	.250	.150	.303	600
10142BZ*	#6 Block	.250	.710	.250	.150	.303	600
10144BZ	#4 Block	.250	.670	.250	.125	.250	600
10146BZ	#6 Wide Block	.250	.730	.30	.149	.303	600
10150BZ*	#8	.250	.730	.344	.175	.303	600
10151BZ*	#8 Snap	.250	.730	.30	.175	.303	600
10152BZ*	#8 Block	.250	.730	.30	.175	.303	600
10158BZ	#8 Slim Block	.250	.710	.260	.175	.303	600
10160BZ*	#10	.250	.730	.344	.205	.303	600
10161BZ*	#10 Snap	.250	.730	.320	.205	.303	600
10162BZ*	#10 Block	.250	.730	.320	.205	.303	600
10165BZ*	1/4	.250	.990	.470	.260	.469	600

All dimensions are in Inches

* =UL and CSA listed

~ =CSA listed

Required per UL/CSA Requirements:

75° C Max. Temperature Rating

One crimp required

Solid or Stranded wire

Crimp tool HT #20591-NH1

Strip Length 1/4" (6.4mm)

Agency and Compliance:

UL Listed, investigated to UL 486 A-B, File NO. ZMVV.E68376

CSA 22.2 No. 65-03, Certification NO. 207131

Min. Wire Pullout Force	16AWG	30lbs.
	14AWG	50lbs.

WARNING! Installation of electrical wire and terminals can be hazardous if done improperly. Improper use can result in personal injury or property damage. For safe wiring practices, consult National Electrical Code and/or your local building inspector. A licensed electrical contractor or engineer must be consulted to determine that the correct wire and terminal size is used and that it is properly and safely installed for all applications.

All statements, procedural information, and recommendations related to Hillsdale Terminal's products are based on data believed to be reliable, but the precision or completeness is not definite. Before using this product, you must evaluate it and determine if it is suitable for your intended application. You accept all risks and liability associated with such use. Any statements related to the product which are not in Hillsdale Terminal's current publications shall have no force or effect unless expressly agreed upon, in writing, by a sanctioned member of Hillsdale Terminal

Terms and Conditions at www.hillsdaleterminal.com

[HOME](#)



Hillsdale Terminal

Phone: 1-800-447-3150

Email: sales@hillsdaleterminal.com

12-10 A.W.G. Brazed Spades

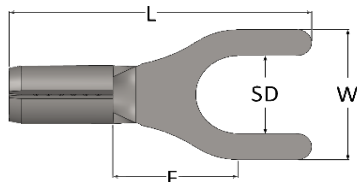

- 110 Copper Alloy .038 thickness, Electro-Tin Plated .00025"-.0004"
- Terminal I.D. - .141/.144

Part #	Stud Size	Barrel Length	Length	W	Stud Diameter(SD)	F	Voltage
10234BZ	1/4	.250	.990	.470	.260	.469	600
10241BZ	1/4 Snap	.250	.990	.470	.212	.469	600
10270BZ*	#6	.250	.720	.350	.149	.294	600
10271BZ*	#6 Snap	.250	.720	.296	.149	.294	600
10272BZ*	#6 Block	.250	.720	.296	.149	.294	600
10280BZ*	#8	.250	.720	.350	.175	.294	600
10281BZ*	#8 Snap	.250	.720	.325	.175	.294	600
10282BZ*	#8 Block	.250	.720	.325	.175	.294	600
10290BZ*	#10	.250	.720	.370	.203	.294	600
10291BZ*	#10 Snap	.250	.720	.350	.203	.294	600
10292BZ*	#10 Block	.250	.720	.350	.203	.294	600

All dimensions are in Inches

* =UL and CSA listed

~ =CSA listed

Required per UL/CSA Requirements:

75° C Max. Temperature Rating

One crimp required

Solid or Stranded wire

Crimp tool HT #20591-NH1

Strip Length 1/4" (6.4mm)

Min. Wire Pullout Force	12AWG	70lbs.
	10AWG	80lbs.

Agency and Compliance:

UL Listed, investigated to UL 486 A-B, File NO. ZMVV.E68376

CSA 22.2 No. 65-03, Certification NO. 207131

WARNING! Installation of electrical wire and terminals can be hazardous if done improperly. Improper use can result in personal injury or property damage. For safe wiring practices, consult National Electrical Code and/or your local building inspector. A licensed electrical contractor or engineer must be consulted to determine that the correct wire and terminal size is used and that it is properly and safely installed for all applications.

All statements, procedural information, and recommendations related to Hillsdale Terminal's products are based on data believed to be reliable, but the precision or completeness is not definite. Before using this product, you must evaluate it and determine if it is suitable for your intended application. You accept all risks and liability associated with such use. Any statements related to the product which are not in Hillsdale Terminal's current publications shall have no force or effect unless expressly agreed upon, in writing, by a sanctioned member of Hillsdale Terminal

Terms and Conditions at www.hillsdaleterminal.com





Hillsdale Terminal

Phone: 1-800-447-3150

Email: sales@hillsdaleterminal.com

22-18 A.W.G. Vinyl Spades

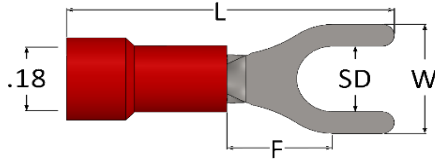

- Terminal I.D. - .078
- 110 Copper Alloy .028 thickness, Electro-Tin Plated .0001"-.0003"
- Rigid PVC Insulator .030 wall thickness

Part #	Stud Size	Barrel Length	Length	W	Stud Diameter(SD)	F	Voltage
50050*	#6	.250	.950	.250	.149	.321	600
50051*	#6 Snap	.250	.950	.250	.149	.321	600
50052*	#6 Block	.250	.950	.250	.149	.321	600
50054	#4	.250	.950	.250	.125	.289	600
50055	#6 Short	.250	.890	.250	.145	.321	600
50056	#6 Block Wide	.250	.890	.30	.149	.321	600
50060*	#8	.250	.950	.312	.175	.321	600
50061*	#8 Snap	.250	.950	.312	.175	.321	600
50062*	#8 Block	.250	.950	.312	.175	.321	600
50063	#8 Flanged	.250	.880	.290	.175	.246	600
50068	#8 Slim	.250	.950	.260	.175	.321	600
50070*	#10	.250	.950	.312	.203	.321	600
50071*	#10 Snap	.250	.950	.312	.203	.321	600
50072*	#10 Block	.250	.950	.312	.203	.321	600
50075	1/4	.250	1.20	.470	.260	.469	600

All dimensions are in Inches

* =UL and CSA listed

~ =CSA listed

Required per UL/CSA Requirements:

75° C Max. Temperature Rating

One crimp required

Solid or Stranded wire

Crimp tool HT #20592-NH30

Strip Length 9/32" (7.1mm)

Agency and Compliance:

UL Listed, investigated to UL 486 A-B, File NO. ZMVV.E68376

CSA 22.2 No. 65-03, Certification NO. 207131

Min. Wire Pullout Force	22AWG	8lbs.
	20AWG	13lbs.
	18AWG	20lbs.

WARNING! Installation of electrical wire and terminals can be hazardous if done improperly. Improper use can result in personal injury or property damage. For safe wiring practices, consult National Electrical Code and/or your local building inspector. A licensed electrical contractor or engineer must be consulted to determine that the correct wire and terminal size is used and that it is properly and safely installed for all applications.

All statements, procedural information, and recommendations related to Hillsdale Terminal's products are based on data believed to be reliable, but the precision or completeness is not definite. Before using this product, you must evaluate it and determine if it is suitable for your intended application. You accept all risks and liability associated with such use. Any statements related to the product which are not in Hillsdale Terminal's current publications shall have no force or effect unless expressly agreed upon, in writing, by a sanctioned member of Hillsdale Terminal

Terms and Conditions at www.hillsdaleterminal.com

HOME



Hillsdale Terminal

Phone: 1-800-447-3150

Email: sales@hillsdaleterminal.com

16-14 A.W.G. Vinyl Spades

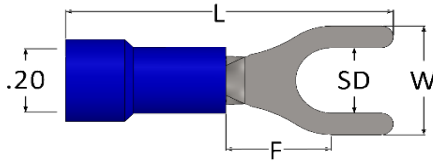

- Terminal I.D. - .093
- 110 Copper Alloy .030 thickness, Electro-Tin Plated .0001"-.0003"
- Rigid PVC Insulator .030 wall thickness

Part #	Stud Size	Barrel Length	Length	W	Stud Diameter(SD)	F	Voltage
50140*	#6	.250	.930	.250	.150	.303	600
50141*	#6 Snap	.250	.930	.250	.150	.303	600
50142*	#6 Block	.250	.930	.250	.150	.303	600
50144	#4 Block	.250	.890	.250	.125	.250	600
50146	#6 Wide	.250	.950	.30	.149	.303	600
50150*	#8	.250	.950	.344	.175	.303	600
50151*	#8 Snap	.250	.950	.30	.175	.303	600
50152*	#8 Block	.250	.950	.30	.175	.303	600
50158	#8 Slim Bloc	.250	.930	.260	.175	.303	600
50160*	#10	.250	.950	.344	.205	.303	600
50161*	#10 Snap	.250	.950	.320	.205	.303	600
50162*	#10 Block	.250	.950	.320	.205	.303	600
50165*	1/4	.250	1.20	.470	.260	.469	600

All dimensions are in Inches

* =UL and CSA listed

~ =CSA listed

Required per UL/CSA Requirements:

75° C Max. Temperature Rating

One crimp required

Solid or Stranded wire

Crimp tool HT #20592-NH30

Strip Length 9/32" (7.1mm)

Min. Wire Pullout Force	16AWG	30lbs.
	14AWG	50lbs.

Agency and Compliance:

UL Listed, investigated to UL 486 A-B, File NO. ZMVV.E68376

CSA 22.2 No. 65-03, Certification NO. 207131

WARNING! Installation of electrical wire and terminals can be hazardous if done improperly. Improper use can result in personal injury or property damage. For safe wiring practices, consult National Electrical Code and/or your local building inspector. A licensed electrical contractor or engineer must be consulted to determine that the correct wire and terminal size is used and that it is properly and safely installed for all applications.

All statements, procedural information, and recommendations related to Hillsdale Terminal's products are based on data believed to be reliable, but the precision or completeness is not definite. Before using this product, you must evaluate it and determine if it is suitable for your intended application. You accept all risks and liability associated with such use. Any statements related to the product which are not in Hillsdale Terminal's current publications shall have no force or effect unless expressly agreed upon, in writing, by a sanctioned member of Hillsdale Terminal

Terms and Conditions at www.hillsdaleterminal.com

[HOME](#)



Hillsdale Terminal

Phone: 1-800-447-3150

Email: sales@hillsdaleterminal.com

12-10 A.W.G. Vinyl Spades

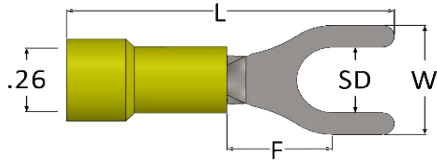

- Terminal I.D. - .141/.144
- 110 Copper Alloy .038 thickness, Electro-Tin Plated .00025"-.0004"
- Rigid PVC Insulator .032 wall thickness

Part #	Stud Size	Barrel Length	Length	W	Stud Diameter(SD)	F	Voltage
50234	1/4	.250	1.220	.470	.260	.469	600
50241	1/4 Snap	.250	1.220	.470	.212	.469	600
50270*	#6	.250	1.020	.350	.149	.294	600
50271*	#6 Snap	.250	1.020	.296	.149	.294	600
50272*	#6 Block	.250	1.020	.296	.149	.294	600
50280*	#8	.250	1.020	.350	.175	.294	600
50281*	#8 Snap	.250	1.020	.325	.175	.294	600
50282*	#8 Block	.250	1.020	.325	.175	.294	600
50290*	#10	.250	1.020	.370	.203	.294	600
50291*	#10 Snap	.250	1.020	.350	.203	.294	600
50292*	#10 Block	.250	1.020	.350	.203	.294	600

All dimensions are in Inches

* =UL and CSA listed

~ =CSA listed

Required per UL/CSA Requirements:

75° C Max. Temperature Rating

One crimp required

Solid or Stranded wire

Crimp tool HT #20593-NH13

Strip Length 9/32" (7.1mm)

Min. Wire Pullout Force	12AWG	70lbs.
	10AWG	80lbs.

Agency and Compliance:

UL Listed, investigated to UL 486 A-B, File NO. ZMVV.E68376

CSA 22.2 No. 65-03, Certification NO. 207131

WARNING! Installation of electrical wire and terminals can be hazardous if done improperly. Improper use can result in personal injury or property damage. For safe wiring practices, consult National Electrical Code and/or your local building inspector. A licensed electrical contractor or engineer must be consulted to determine that the correct wire and terminal size is used and that it is properly and safely installed for all applications.

All statements, procedural information, and recommendations related to Hillsdale Terminal's products are based on data believed to be reliable, but the precision or completeness is not definite. Before using this product, you must evaluate it and determine if it is suitable for your intended application. You accept all risks and liability associated with such use. Any statements related to the product which are not in Hillsdale Terminal's current publications shall have no force or effect unless expressly agreed upon, in writing, by a sanctioned member of Hillsdale Terminal

Terms and Conditions at www.hillsdaleterminal.com

HOME



Hillsdale Terminal

Phone: 1-800-447-3150

Email: sales@hillsdaleterminal.com

22-18 A.W.G. Nylon Spades

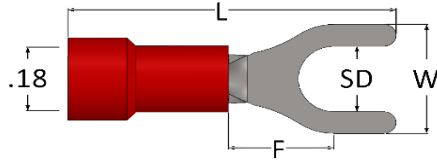

- 110 Copper Alloy .028 thickness, Electro-Tin Plated .0001"-.0003"
- Terminal I.D. - .078

Part #	Stud Size	Barrel Length	Length	W	Stud Diameter(SD)	F	Voltage
50050N*	#6	.250	.950	.250	.149	.321	600
50051N*	#6 Snap	.250	.950	.250	.149	.321	600
50052N*	#6 Block	.250	.950	.250	.149	.321	600
50054N	#4	.250	.950	.250	.125	.289	600
50055N	#6 Short	.250	.890	.250	.145	.321	600
50056N	#6 Block Wide	.250	.890	.30	.149	.321	600
50060N*	#8	.250	.950	.312	.175	.321	600
50061N*	#8 Snap	.250	.950	.312	.175	.321	600
50062N*	#8 Block	.250	.950	.312	.175	.321	600
50068N	#8 Slim	.250	.950	.260	.175	.321	600
50070N*	#10	.250	.950	.312	.203	.321	600
50071N*	#10 Snap	.250	.950	.312	.203	.321	600
50072N*	#10 Block	.250	.950	.312	.203	.321	600
50075N	1/4	.250	1.20	.470	.260	.469	600

All dimensions are in Inches

* =UL and CSA listed

~ =CSA listed

Required per UL/CSA Requirements:

75° C Max. Temperature Rating

One crimp required

Solid or Stranded wire

Crimp tool HT #20592-NH30

Strip Length 9/32" (7.1mm)

Agency and Compliance:

UL Listed, investigated to UL 486 A-B, File NO. ZMVV.E68376

CSA 22.2 No. 65-03, Certification NO. 207131

Min. Wire Pullout Force	22AWG	8lbs.
	20AWG	13lbs.
	18AWG	20lbs.

WARNING! Installation of electrical wire and terminals can be hazardous if done improperly. Improper use can result in personal injury or property damage. For safe wiring practices, consult National Electrical Code and/or your local building inspector. A licensed electrical contractor or engineer must be consulted to determine that the correct wire and terminal size is used and that it is properly and safely installed for all applications.

All statements, procedural information, and recommendations related to Hillsdale Terminal's products are based on data believed to be reliable, but the precision or completeness is not definite. Before using this product, you must evaluate it and determine if it is suitable for your intended application. You accept all risks and liability associated with such use. Any statements related to the product which are not in Hillsdale Terminal's current publications shall have no force or effect unless expressly agreed upon, in writing, by a sanctioned member of Hillsdale Terminal

Terms and Conditions at www.hillsdaleterminal.com





Hillsdale Terminal

Phone: 1-800-447-3150

Email: sales@hillsdaleterminal.com

16-14 A.W.G. Nylon Spades

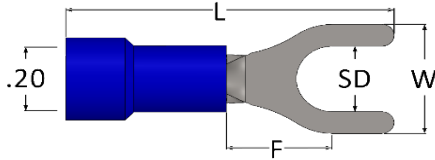

- 110 Copper Alloy .030 thickness, Electro-Tin Plated .0001"-.0003"
- Terminal I.D. - .093

Part #	Stud Size	Barrel Length	Length	W	Stud Diameter(SD)	F	Voltage
50140N*	#6	.250	.930	.250	.150	.303	600
50141N*	#6 Snap	.250	.930	.250	.150	.303	600
50142N*	#6 Block	.250	.930	.250	.150	.303	600
50144N	#4 Block	.250	.890	.250	.125	.250	600
50146N	#6 Wide	.250	.950	.30	.149	.303	600
50150N*	#8	.250	.950	.344	.175	.303	600
50151N*	#8 Snap	.250	.950	.30	.175	.303	600
50152N*	#8 Block	.250	.950	.30	.175	.303	600
50158N	#8 Slim Bloc	.250	.930	.260	.175	.303	600
50160N*	#10	.250	.950	.344	.205	.303	600
50161N*	#10 Snap	.250	.950	.320	.205	.303	600
50162N*	#10 Block	.250	.950	.320	.205	.303	600
50165N*	1/4	.250	1.20	.470	.260	.469	600

All dimensions are in Inches

* =UL and CSA listed

~ =CSA listed

Required per UL/CSA Requirements:

75° C Max. Temperature Rating

One crimp required

Solid or Stranded wire

Crimp tool HT #20592-NH30

Strip Length 9/32" (7.1mm)

Min. Wire Pullout Force	16AWG	30lbs.
	14AWG	50lbs.

Agency and Compliance:

UL Listed, investigated to UL 486 A-B, File NO. ZMVV.E68376

CSA 22.2 No. 65-03, Certification NO. 207131

WARNING! Installation of electrical wire and terminals can be hazardous if done improperly. Improper use can result in personal injury or property damage. For safe wiring practices, consult National Electrical Code and/or your local building inspector. A licensed electrical contractor or engineer must be consulted to determine that the correct wire and terminal size is used and that it is properly and safely installed for all applications.

All statements, procedural information, and recommendations related to Hillsdale Terminal's products are based on data believed to be reliable, but the precision or completeness is not definite. Before using this product, you must evaluate it and determine if it is suitable for your intended application. You accept all risks and liability associated with such use. Any statements related to the product which are not in Hillsdale Terminal's current publications shall have no force or effect unless expressly agreed upon, in writing, by a sanctioned member of Hillsdale Terminal

Terms and Conditions at www.hillsdaleterminal.com

HOME



Hillsdale Terminal

Phone: 1-800-447-3150

Email: sales@hillsdaleterminal.com

12-10 A.W.G. Nylon Spades

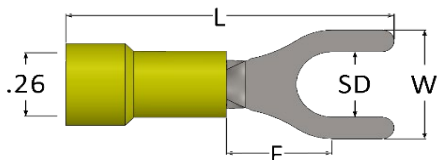

- 110 Copper Alloy .038 thickness, Electro-Tin Plated .00025"-.0004"
- Terminal I.D. - .141/.144

Part #	Stud Size	Barrel Length	Length	W	Stud Diameter(SD)	F	Voltage
50234N	1/4	.250	1.220	.470.0	.260	.469	600
50241N	1/4 Snap	.250	1.220	.470	.212	.469	600
50270N*	#6	.250	1.020	.350	.149	.294	600
50271N*	#6 Snap	.250	1.020	.296	.149	.294	600
50272N*	#6 Block	.250	1.020	.296	.149	.294	600
50280N*	#8	.250	1.020	.350	.175	.294	600
50281N*	#8 Snap	.250	1.020	.325	.175	.294	600
50282N*	#8 Block	.250	1.020	.325	.175	.294	600
50290N*	#10	.250	1.020	.370	.203	.294	600
50291N*	#10 Snap	.250	1.020	.350	.203	.294	600
50292N*	#10 Block	.250	1.020	.350	.203	.294	600

All dimensions are in Inches

* =UL and CSA listed

~ =CSA listed

Required per UL/CSA Requirements:

75° C Max. Temperature Rating

One crimp required

Solid or Stranded wire

Crimp tool HT #20593-NH13

Strip Length 9/32" (7.1mm)

Agency and Compliance:

UL Listed, investigated to UL 486 A-B, File NO. ZMVV.E68376

CSA 22.2 No. 65-03, Certification NO. 207131

Min. Wire Pullout Force	12AWG	70lbs.
	10AWG	80lbs.

WARNING! Installation of electrical wire and terminals can be hazardous if done improperly. Improper use can result in personal injury or property damage. For safe wiring practices, consult National Electrical Code and/or your local building inspector. A licensed electrical contractor or engineer must be consulted to determine that the correct wire and terminal size is used and that it is properly and safely installed for all applications.

All statements, procedural information, and recommendations related to Hillsdale Terminal's products are based on data believed to be reliable, but the precision or completeness is not definite. Before using this product, you must evaluate it and determine if it is suitable for your intended application. You accept all risks and liability associated with such use. Any statements related to the product which are not in Hillsdale Terminal's current publications shall have no force or effect unless expressly agreed upon, in writing, by a sanctioned member of Hillsdale Terminal

Terms and Conditions at www.hillsdaleterminal.com

[HOME](#)



Hillsdale Terminal

Phone: 1-800-447-3150

Email: sales@hillsdaleterminal.com

22-18 A.W.G. 3-Piece Spades

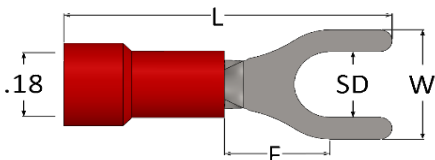

- 110 Copper Alloy .028 thickness, Electro-Tin Plated .0001"-.0003"
- Terminal I.D. - .078

Part #	Stud Size	Barrel Length	Length	W	Stud Diameter(SD)	F	Voltage
30050	#6	.250	.930	.250	.149	.321	600
30051	#6 Snap	.250	.930	.250	.149	.321	600
30052	#6 Block	.250	.930	.250	.149	.321	600
30054	#4	.250	.930	.250	.125	.289	600
30055	#6 Short	.250	.930	.250	.145	.321	600
30056	#6 Block Wide	.250	.930	.30	.149	.321	600
30060	#8	.250	.930	.312	.175	.321	600
30061	#8 Snap	.250	.930	.312	.175	.321	600
30062	#8 Block	.250	.930	.312	.175	.321	600
30068	#8 Slim	.250	.930	.260	.175	.321	600
30070	#10	.250	.930	.312	.203	.321	600
30071	#10 Snap	.250	.930	.312	.203	.321	600
30072	#10 Block	.250	.930	.312	.203	.321	600
30075	1/4	.250	1.190	.470	.260	.469	600

All dimensions are in Inches

* =UL and CSA listed

~ =CSA listed

Required per UL/CSA Requirements:

75° C Max. Temperature Rating

One crimp required

Solid or Stranded wire

Crimp tool HT #20592-NH30

Strip Length 9/32" (7.1mm)

Agency and Compliance:

UL Listed, investigated to UL 486 A-B, File NO. ZMVV.E68376

CSA 22.2 No. 65-03, Certification NO. 207131

Min. Wire Pullout Force	22AWG	8lbs.
	20AWG	13lbs.
	18AWG	20lbs.

WARNING! Installation of electrical wire and terminals can be hazardous if done improperly. Improper use can result in personal injury or property damage. For safe wiring practices, consult National Electrical Code and/or your local building inspector. A licensed electrical contractor or engineer must be consulted to determine that the correct wire and terminal size is used and that it is properly and safely installed for all applications.

All statements, procedural information, and recommendations related to Hillsdale Terminal's products are based on data believed to be reliable, but the precision or completeness is not definite. Before using this product, you must evaluate it and determine if it is suitable for your intended application. You accept all risks and liability associated with such use. Any statements related to the product which are not in Hillsdale Terminal's current publications shall have no force or effect unless expressly agreed upon, in writing, by a sanctioned member of Hillsdale Terminal

Terms and Conditions at www.hillsdaleterminal.com

HOME



Hillsdale Terminal

Phone: 1-800-447-3150

Email: sales@hillsdaleterminal.com

16-14 A.W.G. 3-Piece Spades

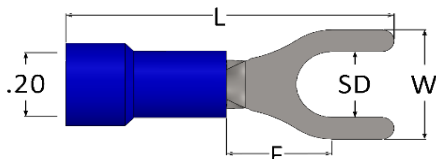

- 110 Copper Alloy .030 thickness, Electro-Tin Plated .0001"-.0003"
- Terminal I.D. - .093

Part #	Stud Size	Barrel Length	Length	W	Stud Diameter(SD)	F	Voltage
30140	#6	.250	.910	.250	.150	.303	600
30141	#6 Snap	.250	.910	.250	.150	.303	600
30142	#6 Block	.250	.930	.250	.150	.303	600
30144	#4 Block	.250	.890	.250	.125	.250	600
30146	#6 Wide	.250	.950	.30	.149	.303	600
30150	#8	.250	.970	.344	.175	.303	600
30151	#8 Snap	.250	.970	.30	.175	.303	600
30152	#8 Block	.250	.970	.30	.175	.303	600
30158	#8 Slim Block	.250	.940	.260	.175	.303	600
30160	#10	.250	.940	.344	.205	.303	600
30161	#10 Snap	.250	.940	.320	.205	.303	600
30162	#10 Block	.250	.940	.320	.205	.303	600
30165	1/4	.250	1.190	.470	.260	.469	600

All dimensions are in Inches

* =UL and CSA listed

~ =CSA listed

Required per UL/CSA Requirements:

75° C Max. Temperature Rating

One crimp required

Solid or Stranded wire

Crimp tool HT #20592-NH30

Strip Length 9/32" (7.1mm)

Min. Wire Pullout Force	16AWG	30lbs.
	14AWG	50lbs.

Agency and Compliance:

UL Listed, investigated to UL 486 A-B, File NO. ZMVV.E68376

CSA 22.2 No. 65-03, Certification NO. 207131

WARNING! Installation of electrical wire and terminals can be hazardous if done improperly. Improper use can result in personal injury or property damage. For safe wiring practices, consult National Electrical Code and/or your local building inspector. A licensed electrical contractor or engineer must be consulted to determine that the correct wire and terminal size is used and that it is properly and safely installed for all applications.

All statements, procedural information, and recommendations related to Hillsdale Terminal's products are based on data believed to be reliable, but the precision or completeness is not definite. Before using this product, you must evaluate it and determine if it is suitable for your intended application. You accept all risks and liability associated with such use. Any statements related to the product which are not in Hillsdale Terminal's current publications shall have no force or effect unless expressly agreed upon, in writing, by a sanctioned member of Hillsdale Terminal

Terms and Conditions at www.hillsdaleterminal.com

HOME



Hillsdale Terminal

Phone: 1-800-447-3150

Email: sales@hillsdaleterminal.com

12-10 A.W.G. 3-Piece Spades

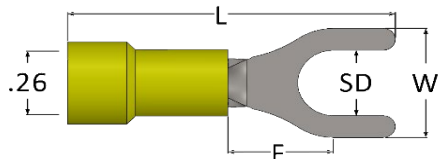

- 110 Copper Alloy .038 thickness, Electro-Tin Plated .00025"-.0004"
- Terminal I.D. - .141/.144

Part #	Stud Size	Barrel Length	Length	W	Stud Diameter(SD)	F	Voltage
30234	1/4	.250	1.190	.470	.260	.469	600
30241	1/4 Snap	.250	1.30	.470	.212	.469	600
30270	#6	.250	1.020	.350	.149	.294	600
30271	#6 Snap	.250	1.020	.296	.149	.294	600
30272	#6 Block	.250	1.020	.296	.149	.294	600
30280	#8	.250	1.020	.350	.175	.294	600
30281	#8 Snap	.250	1.020	.325	.175	.294	600
30282	#8 Block	.250	1.020	.325	.175	.294	600
30290	#10	.250	1.020	.370	.203	.294	600
30291	#10 Snap	.250	1.020	.350	.203	.294	600
30292	#10 Block	.250	1.020	.350	.203	.294	600

All dimensions are in Inches

* =UL and CSA listed

~ =CSA listed

Required per UL/CSA Requirements:

75° C Max. Temperature Rating

One crimp required

Solid or Stranded wire

Crimp tool HT #20593-NH13

Strip Length 9/32" (7.1mm)

Min. Wire Pullout Force	12AWG	70lbs.
	10AWG	80lbs.

Agency and Compliance:

UL Listed, investigated to UL 486 A-B, File NO. ZMVV.E68376

CSA 22.2 No. 65-03, Certification NO. 207131

WARNING! Installation of electrical wire and terminals can be hazardous if done improperly. Improper use can result in personal injury or property damage. For safe wiring practices, consult National Electrical Code and/or your local building inspector. A licensed electrical contractor or engineer must be consulted to determine that the correct wire and terminal size is used and that it is properly and safely installed for all applications.

All statements, procedural information, and recommendations related to Hillsdale Terminal's products are based on data believed to be reliable, but the precision or completeness is not definite. Before using this product, you must evaluate it and determine if it is suitable for your intended application. You accept all risks and liability associated with such use. Any statements related to the product which are not in Hillsdale Terminal's current publications shall have no force or effect unless expressly agreed upon, in writing, by a sanctioned member of Hillsdale Terminal

Terms and Conditions at www.hillsdaleterminal.com

[HOME](#)



Hillsdale Terminal

Phone: 1-800-447-3150

Email: sales@hillsdaleterminal.com

22-18 A.W.G. Heat Shrink Spades

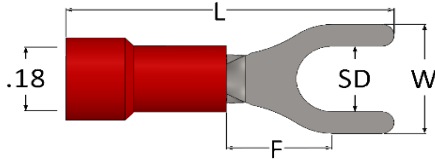

- 110 Copper Alloy .028 thickness, Electro-Tin Plated .0001"-.0003"
- Terminal I.D. - .078

Part #	Stud Size	Barrel Length	Length	W	Stud Diameter(SD)	F	Voltage
40050	#6	.250	1.20	.250	.149	.321	600
40051	#6 Snap	.250	1.20	.250	.149	.321	600
40052	#6 Block	.250	1.20	.250	.149	.321	600
40054	#4	.250	1.20	.250	.125	.289	600
40055	#6 Short	.250	1.140	.250	.145	.321	600
40056	#6 Block Wide	.250	1.20	.30	.149	.321	600
40060	#8	.250	1.20	.312	.175	.321	600
40061	#8 Snap	.250	1.20	.312	.175	.321	600
40062	#8 Block	.250	1.20	.312	.175	.321	600
40068	#8 Slim	.250	1.20	.260	.175	.321	600
40070	#10	.250	1.20	.312	.203	.321	600
40071	#10 Snap	.250	1.20	.312	.203	.321	600
40072	#10 Block	.250	1.20	.312	.203	.321	600
40075	1/4	.250	1.20	.470	.260	.469	600

All dimensions are in Inches

* =UL and CSA listed

~ =CSA listed

Required per UL/CSA Requirements:

75° C Max. Temperature Rating

One crimp required

Solid or Stranded wire

Crimp tool HT #20596

Strip Length 9/32" (7.1mm)

Agency and Compliance:

UL Listed, investigated to UL 486 A-B, File NO. ZMVV.E68376

CSA 22.2 No. 65-03, Certification NO. 207131

Min. Wire Pullout Force	22AWG	8lbs.
	20AWG	13lbs.
	18AWG	20lbs.

WARNING! Installation of electrical wire and terminals can be hazardous if done improperly. Improper use can result in personal injury or property damage. For safe wiring practices, consult National Electrical Code and/or your local building inspector. A licensed electrical contractor or engineer must be consulted to determine that the correct wire and terminal size is used and that it is properly and safely installed for all applications.

All statements, procedural information, and recommendations related to Hillsdale Terminal's products are based on data believed to be reliable, but the precision or completeness is not definite. Before using this product, you must evaluate it and determine if it is suitable for your intended application. You accept all risks and liability associated with such use. Any statements related to the product which are not in Hillsdale Terminal's current publications shall have no force or effect unless expressly agreed upon, in writing, by a sanctioned member of Hillsdale Terminal

Terms and Conditions at www.hillsdaleterminal.com

HOME



Hillsdale Terminal

Phone: 1-800-447-3150

Email: sales@hillsdaleterminal.com

16-14 A.W.G. Heat Shrink Spades

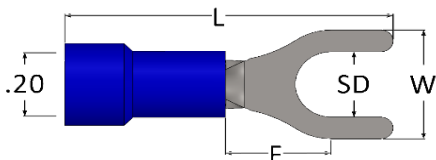

- 110 Copper Alloy .030 thickness, Electro-Tin Plated .0001"-.0003"
- Terminal I.D. - .093

Part #	Stud Size	Barrel Length	Length	W	Stud Diameter(SD)	F	Voltage
40140	#6	.250	1.180	.250	.150	.303	600
40141	#6 Snap	.250	1.180	.250	.150	.303	600
40142	#6 Block	.250	1.180	.250	.150	.303	600
40144	#4 Block	.250	1.140	.250	.125	.250	600
40146	#6 Wide	.250	1.20	.30	.149	.303	600
40150	#8	.250	1.20	.344	.175	.303	600
40151	#8 Snap	.250	1.20	.30	.175	.303	600
40152	#8 Block	.250	1.20	.30	.175	.303	600
40158	#8 Slim Block	.250	1.20	.260	.175	.303	600
40160	#10	.250	1.20	.344	.205	.303	600
40161	#10 Snap	.250	1.20	.320	.205	.303	600
40162	#10 Block	.250	1.20	.320	.205	.303	600
40165	1/4	.250	1.450	.470	.260	.469	600

All dimensions are in Inches

* =UL and CSA listed

~ =CSA listed

Required per UL/CSA Requirements:

75° C Max. Temperature Rating

One crimp required

Solid or Stranded wire

Crimp tool HT #20596

Strip Length 9/32" (7.1mm)

Min. Wire Pullout Force	16AWG	30lbs.
	14AWG	50lbs.

Agency and Compliance:

UL Listed, investigated to UL 486 A-B, File NO. ZMVV.E68376

CSA 22.2 No. 65-03, Certification NO. 207131

WARNING! Installation of electrical wire and terminals can be hazardous if done improperly. Improper use can result in personal injury or property damage. For safe wiring practices, consult National Electrical Code and/or your local building inspector. A licensed electrical contractor or engineer must be consulted to determine that the correct wire and terminal size is used and that it is properly and safely installed for all applications.

All statements, procedural information, and recommendations related to Hillsdale Terminal's products are based on data believed to be reliable, but the precision or completeness is not definite. Before using this product, you must evaluate it and determine if it is suitable for your intended application. You accept all risks and liability associated with such use. Any statements related to the product which are not in Hillsdale Terminal's current publications shall have no force or effect unless expressly agreed upon, in writing, by a sanctioned member of Hillsdale Terminal

Terms and Conditions at www.hillsdaleterminal.com

HOME



Hillsdale Terminal

Phone: 1-800-447-3150

Email: sales@hillsdaleterminal.com

12-10 A.W.G. Heat Shrink Spades

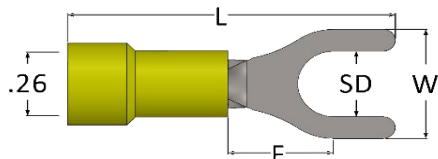

- 110 Copper Alloy .038 thickness, Electro-Tin Plated .00025"-.0004"
- Terminal I.D. - .141/.144

Part #	Stud Size	Barrel Length	Length	W	Stud Diameter(SD)	F	Voltage
40234	1/4	.250	1.50	.470	.260	.469	600
40241	1/4 Snap	.250	1.50	.470	.212	.469	600
40270	#6	.250	1.250	.350	.149	.294	600
40271	#6 Snap	.250	1.250	.296	.149	.294	600
40272	#6 Block	.250	1.250	.296	.149	.294	600
40280	#8	.250	1.250	.350	.175	.294	600
40281	#8 Snap	.250	1.250	.325	.175	.294	600
40282	#8 Block	.250	1.250	.325	.175	.294	600
40290	#10	.250	1.250	.370	.203	.294	600
40291	#10 Snap	.250	1.250	.350	.203	.294	600
40292	#10 Block	.250	1.250	.350	.203	.294	600

All dimensions are in Inches

* =UL and CSA listed

~ =CSA listed

Required per UL/CSA Requirements:

75° C Max. Temperature Rating

One crimp required

Solid or Stranded wire

Crimp tool HT #20596

Strip Length 9/32" (7.1mm)

Min. Wire Pullout Force	12AWG	70lbs.
	10AWG	80lbs.

Agency and Compliance:

UL Listed, investigated to UL 486 A-B, File NO. ZMVV.E68376

CSA 22.2 No. 65-03, Certification NO. 207131

WARNING! Installation of electrical wire and terminals can be hazardous if done improperly. Improper use can result in personal injury or property damage. For safe wiring practices, consult National Electrical Code and/or your local building inspector. A licensed electrical contractor or engineer must be consulted to determine that the correct wire and terminal size is used and that it is properly and safely installed for all applications.

All statements, procedural information, and recommendations related to Hillsdale Terminal's products are based on data believed to be reliable, but the precision or completeness is not definite. Before using this product, you must evaluate it and determine if it is suitable for your intended application. You accept all risks and liability associated with such use. Any statements related to the product which are not in Hillsdale Terminal's current publications shall have no force or effect unless expressly agreed upon, in writing, by a sanctioned member of Hillsdale Terminal

Terms and Conditions at www.hillsdaleterminal.com

[HOME](#)

st

ut

's



Hillsdale Terminal

Phone: 1-800-447-3150

Email: sales@hillsdaleterminal.com

Uninsulated Butts

- 110 Copper Alloy Butted Seam
- 102 Copper Alloy Seamless
- Electro-Tin plated terminal .00025"-.0004"

Part #	A.W.G.	Length	Term I.D.	Insulator Bell I.D.	Material Thickness	Crimp Tool
10080*	22-18	0.56	0.077	NA	0.028	20591-NH1
10170*	16-14	0.56	0.092	NA	0.03	20591-NH1
10310*	12-10	0.625	0.14	NA	0.036	20591-NH1
10624~	8 Seamless	0.827	0.177	NA	0.049	20701 or 20702
10625~	6 Seamless	1.03	0.236	NA	0.058	20701 or 20702
10626~	4 Seamless	1.14	0.3	NA	0.07	20701 or 20702
10627~	2 Seamless	1.25	0.37	NA	0.072	20701 or 20702
10083~	22-18 Seamless	0.565	0.073	NA	0.03	20591-NH1
10173~	16-14 Seamless	0.565	0.092	NA	0.03	20591-NH1
10313~	12-10 Seamless	0.625	0.14	NA	0.036	20591-NH1
10313L~	12-10 Seamless	0.81	0.142	NA	0.035	20591-NH1

All dimensions are in Inches

* =UL and CSA listed

~ =CSA listed

Required per UL/CSA Requirements:

75° C Max. Temperature Rating

One crimp required

Solid or Stranded wire

Agency and Compliance:

UL Listed, investigated to UL 486 A-B, File NO. ZMVV.E68376

CSA 22.2 No. 65-03, Certification NO. 207131

Min. Wire Pullout Force	
8AWG: 90lbs.	22AWG: 8lbs.
6AWG: 100lbs.	20AWG: 13lbs.
4AWG: 140lbs.	18AWG: 20lbs.
2AWG: 180lbs.	16AWG: 30lbs.
	14AWG: 50lbs.
	12AWG: 70lbs.
	10AWG: 80lbs.

WARNING! Installation of electrical wire and terminals can be hazardous if done improperly. Improper use can result in personal injury or property damage. For safe wiring practices, consult National Electrical Code and/or your local building inspector. A licensed electrical contractor or engineer must be consulted to determine that the correct wire and terminal size is used and that it is properly and safely installed for all applications.

All statements, procedural information, and recommendations related to Hillsdale Terminal's products are based on data believed to be reliable, but the precision or completeness is not definite. Before using this product, you must evaluate it and determine if it is suitable for your intended application. You accept all risks and liability associated with such use. Any statements related to the product which are not in Hillsdale Terminal's current publications shall have no force or effect unless expressly agreed upon, in writing, by a sanctioned member of Hillsdale Terminal

Terms and Conditions at www.hillsdaleterminal.com





Hillsdale Terminal

Phone: 1-800-447-3150

Email: sales@hillsdaleterminal.com

Vinyl Extruded Butts

- 110 Copper Alloy Butted Seam
- 102 Copper Alloy Seamless
- Electro-Tin plated terminal .00025"-.0004"

Part #	A.W.G.	Length	Term I.D.	Insulator Bell I.D.	Material Thickness	Crimp Tool
20080*	22-18	0.97	0.077	0.16	0.028	20592-NH30
20170*	16-14	0.97	0.092	0.18	0.03	20592-NH30
20310*	12-10	1.06	0.14	0.235	0.036	20593-NH13
20624~	8 Seamless	1.46	0.177	0.32	0.072	20701 or 20702
20625~	6 Seamless	1.74	0.236	0.395	0.072	20701 or 20702
20626~	4 Seamless	1.93	0.3	0.5	0.072	20701 or 20702
20627~	2 Seamless	2.25	0.37	0.56	0.072	20701 or 20702
20080SV~	22-18 Seamless	0.97	0.073	0.16	0.03	20592-NH30
20170SV~	16-14 Seamless	0.97	0.092	0.18	0.03	20592-NH30
20310SV~	12-10 Seamless	1.06	0.14	0.235	0.036	20593-NH13

All dimensions are in Inches

* =UL and CSA listed

~ =CSA listed

Required per UL/CSA Requirements:

75° C Max. Temperature Rating

One crimp required

Solid or Stranded wire

Min. Wire Pullout Force	
8AWG: 90lbs.	22AWG: 8lbs.
6AWG: 100lbs.	20AWG: 13lbs.
4AWG: 140lbs.	18AWG: 20lbs.
2AWG: 180lbs.	16AWG: 30lbs.
	14AWG: 50lbs.
	12AWG: 70lbs.
	10AWG: 80lbs.

Agency and Compliance:

UL Listed, investigated to UL 486 A-B, File NO. ZMVV.E68376

CSA 22.2 No. 65-03, Certification NO. 207131

WARNING! Installation of electrical wire and terminals can be hazardous if done improperly. Improper use can result in personal injury or property damage. For safe wiring practices, consult National Electrical Code and/or your local building inspector. A licensed electrical contractor or engineer must be consulted to determine that the correct wire and terminal size is used and that it is properly and safely installed for all applications.

All statements, procedural information, and recommendations related to Hillsdale Terminal's products are based on data believed to be reliable, but the precision or completeness is not definite. Before using this product, you must evaluate it and determine if it is suitable for your intended application. You accept all risks and liability associated with such use. Any statements related to the product which are not in Hillsdale Terminal's current publications shall have no force or effect unless expressly agreed upon, in writing, by a sanctioned member of Hillsdale Terminal

Terms and Conditions at www.hillsdaleterminal.com





Hillsdale Terminal

Phone: 1-800-447-3150

Email: sales@hillsdaleterminal.com

Nylon Extruded Butts

- 110 Copper Alloy Butted Seam
- 102 Copper Alloy Seamless
- Electro-Tin plated terminal .00025"-.0004"

Part #	A.W.G.	Length	Term I.D.	Insulator Bell I.D.	Material Thickness	Crimp Tool
20081	22-18	0.97	0.077	0.16	0.028	20592-NH30
20171	16-14	0.97	0.092	0.18	0.03	20592-NH30
20311	12-10	1.06	0.14	0.235	0.036	20593-NH13
20624N~	8 Seamless	1.46	0.177	0.32	0.072	20701 or 20702
20625N~	6 Seamless	1.74	0.236	0.395	0.072	20701 or 20702
20626N~	4 Seamless	1.93	0.3	0.5	0.072	20701 or 20702
20627N~	2 Seamless	2.25	0.37	0.56	0.072	20701 or 20702
20083S~	22-18 Seamless	0.97	0.073	0.16	0.03	20592-NH30
20173S~	16-14 Seamless	0.97	0.092	0.18	0.03	20592-NH30
20313S~	12-10 Seamless	1.06	0.14	0.235	0.036	20593-NH13

All dimensions are in Inches

* =UL and CSA listed

~ =CSA listed

Required per UL/CSA Requirements:

75° C Max. Temperature Rating
 One crimp required
 Solid or Stranded wire

Min. Wire Pullout Force	
8AWG: 90lbs.	22AWG: 8lbs.
6AWG: 100lbs.	20AWG: 13lbs.
4AWG: 140lbs.	18AWG: 20lbs.
2AWG: 180lbs.	16AWG: 30lbs.
	14AWG: 50lbs.
	12AWG: 70lbs.
	10AWG: 80lbs.

Agency and Compliance:

UL Listed, investigated to UL 486 A-B, File NO. ZMVV.E68376
 CSA 22.2 No. 65-03, Certification NO. 207131

WARNING! Installation of electrical wire and terminals can be hazardous if done improperly. Improper use can result in personal injury or property damage. For safe wiring practices, consult National Electrical Code and/or your local building inspector. A licensed electrical contractor or engineer must be consulted to determine that the correct wire and terminal size is used and that it is properly and safely installed for all applications.

All statements, procedural information, and recommendations related to Hillsdale Terminal's products are based on data believed to be reliable, but the precision or completeness is not definite. Before using this product, you must evaluate it and determine if it is suitable for your intended application. You accept all risks and liability associated with such use. Any statements related to the product which are not in Hillsdale Terminal's current publications shall have no force or effect unless expressly agreed upon, in writing, by a sanctioned member of Hillsdale Terminal

Terms and Conditions at www.hillsdaleterminal.com





Hillsdale Terminal

Phone: 1-800-447-3150

Email: sales@hillsdaleterminal.com

Nylon Molded Butts

- 110 Copper Alloy Butted Seam
- 102 Copper Alloy Seamless
- Electro-Tin plated terminal .00025"-.0004"

Part #	A.W.G.	Length	Term I.D.	Insulator Bell I.D.	Material Thickness	Crimp Tool
50081	22-18	0.985	0.077	0.165	0.028	20592-NH30
50171	16-14	0.985	0.092	0.195	0.03	20592-NH30
50311	12-10	1.07	0.14	0.27	0.036	20593-NH13
20083	22-18 Seamless	0.985	0.073	0.165	0.03	20592-NH30
20173	16-14 Seamless	0.985	0.092	0.195	0.03	20592-NH30
20313	12-10 Seamless	1.07	0.14	0.27	0.036	20593-NH13

All dimensions are in Inches

* =UL and CSA listed

~ =CSA listed

Required per UL/CSA Requirements:

75° C Max. Temperature Rating
 One crimp required
 Solid or Stranded wire

Agency and Compliance:

UL Listed, investigated to UL 486 A-B, File NO. ZMVV.E68376
 CSA 22.2 No. 65-03, Certification NO. 207131

Min. Wire Pullout Force

22AWG: 8lbs.
20AWG: 13lbs.
18AWG: 20lbs.
16AWG: 30lbs.
14AWG: 50lbs.
12AWG: 70lbs.
10AWG: 80lbs.

WARNING! Installation of electrical wire and terminals can be hazardous if done improperly. Improper use can result in personal injury or property damage. For safe wiring practices, consult National Electrical Code and/or your local building inspector. A licensed electrical contractor or engineer must be consulted to determine that the correct wire and terminal size is used and that it is properly and safely installed for all applications.

All statements, procedural information, and recommendations related to Hillsdale Terminal's products are based on data believed to be reliable, but the precision or completeness is not definite. Before using this product, you must evaluate it and determine if it is suitable for your intended application. You accept all risks and liability associated with such use. Any statements related to the product which are not in Hillsdale Terminal's current publications shall have no force or effect unless expressly agreed upon, in writing, by a sanctioned member of Hillsdale Terminal

Terms and Conditions at www.hillsdaleterminal.com

[HOME](#)



Hillsdale Terminal

Phone: 1-800-447-3150

Email: sales@hillsdaleterminal.com

Heat Shrink Butts

- 102 Copper Alloy Seamless
- Electro-Tin plated terminal .00025"-.0004"

Part #	A.W.G.	Length	Term I.D.	Insulator Bell I.D.	Material Thickness
*20082	22-18	1.50	0.072	0.18	0.030
*20172	16-14	1.50	0.097	0.22	0.032
*20312	12-10	1.70	0.142	0.27	0.038
*40624	8	1.88	0.177	0.33	0.050

All dimensions are in Inches

* =UL Listed

Required per UL/CSA Requirements:

75° C Max. Temperature Rating

One crimp required

Solid or Stranded wire

Crimp tool HT #20596

Strip Length 9/32" (7.1mm)

Agency and Compliance:

UL Listed, investigated to UL 486 A-B, File NO. ZMVB.E68376

Min. Wire Pullout Force

22AWG: 8lbs.

20AWG: 13lbs.

18AWG: 20lbs.

16AWG: 30lbs.

14AWG: 50lbs.

12AWG: 70lbs.

10AWG: 80lbs.

8AWG: 90lbs.

WARNING! Installation of electrical wire and terminals can be hazardous if done improperly. Improper use can result in personal injury or property damage. For safe wiring practices, consult National Electrical Code and/or your local building inspector. A licensed electrical contractor or engineer must be consulted to determine that the correct wire and terminal size is used and that it is properly and safely installed for all applications.

All statements, procedural information, and recommendations related to Hillsdale Terminal's products are based on data believed to be reliable, but the precision or completeness is not definite. Before using this product, you must evaluate it and determine if it is suitable for your intended application. You accept all risks and liability associated with such use. Any statements related to the product which are not in Hillsdale Terminal's current publications shall have no force or effect unless expressly agreed upon, in writing, by a sanctioned member of Hillsdale Terminal

Terms and Conditions at www.hillsdaleterminal.com

HOME



Hillsdale Terminal

Phone: 1-800-447-3150

Email: sales@hillsdaleterminal.com

Economy Butts

- 110 Copper Alloy Butted Seam
- 102 Copper Alloy Seamless
- Electro-Tin plated terminal .00025"-.0004"

Part #	A.W.G.	Length	Term I.D.	Insulator Bell I.D.	Material Thickness	Crimp Tool
10080E	22-18	0.56	0.077	0.16	0.02	20592-NH30
10170E	16-14	0.56	0.092	0.18	0.02	20592-NH30
10310E	12-10	0.625	0.14	0.235	0.03	20593-NH13
20080E	22-18	0.97	0.073	0.16	0.02	20592-NH30
20170E	16-14	0.97	0.092	0.18	0.02	20592-NH30
20310E	12-10	1.06	0.14	0.235	0.03	20593-NH13

All dimensions are in Inches

* =UL and CSA listed

~ =CSA listed

Required per UL/CSA Requirements:

75° C Max. Temperature Rating
One crimp required
Solid or Stranded wire

Agency and Compliance:

UL Listed, investigated to UL 486 A-B, File NO. ZMVF.E68376
CSA 22.2 No. 65-03, Certification NO. 207131

Min. Wire Pullout Force

22AWG: 8lbs.
20AWG: 13lbs.
18AWG: 20lbs.
16AWG: 30lbs.
14AWG: 50lbs.
12AWG: 70lbs.
10AWG: 80lbs.

WARNING! Installation of electrical wire and terminals can be hazardous if done improperly. Improper use can result in personal injury or property damage. For safe wiring practices, consult National Electrical Code and/or your local building inspector. A licensed electrical contractor or engineer must be consulted to determine that the correct wire and terminal size is used and that it is properly and safely installed for all applications.

All statements, procedural information, and recommendations related to Hillsdale Terminal's products are based on data believed to be reliable, but the precision or completeness is not definite. Before using this product, you must evaluate it and determine if it is suitable for your intended application. You accept all risks and liability associated with such use. Any statements related to the product which are not in Hillsdale Terminal's current publications shall have no force or effect unless expressly agreed upon, in writing, by a sanctioned member of Hillsdale Terminal

Terms and Conditions at www.hillsdaleterminal.com

[HOME](#)